

**HALTEC**  
CORPORATION

SINCE 1970

# Table of Contents

Policy/Warranty .....	1
Safety Precautions .....	1
New Products .....	2-3
Large Bore Valve System .....	4-10
Super Large Bore Valve System .....	11-15
Z-Bore Valve System .....	16-17
PT Valve System .....	18-19
Mega Bore Valve System .....	20-21
O-Rings and L-Rings .....	22
Truck and Bus Valves .....	23-24
Cars, Lt. Trucks and Miscellaneous Valves .....	25
Valve Extensions .....	26-27
Special Application Products .....	28-29
Air Liquid Valves, Tools and Accessories .....	30
Liquid Full Tools .....	31
Valve Cores, Caps and Adapters .....	32
Grommets, Hex Nuts, Washers and O-Rings .....	33
Service Gauges .....	34-35
Digital & Dial Gauges .....	36
Large Bore Gauges, Service Tools and Chucks .....	37-38
Standard Bore Air Chucks .....	39-40
Standard Bore Tools .....	41
Automatic Tire Inflation Systems .....	42
Air Inflation System Accessories .....	43
Nitrogen Inflation Systems .....	44
Nitrogen Inflation System Accessories .....	45
Manual Inflators .....	46-47
Couplers and Nipples .....	48-49
Alcoa Accessories .....	50
16" Alcoa Wheel Accessories .....	51
Alcoa Forged Alum. Wheel Mounting Hardware .....	52
Alcoa Wheel Cover Kits .....	53
Alcoa Steer Hub Cover Kits .....	54
Alcoa Rear Hub Cover Kits .....	55
Alcoa Hub Cover Kits .....	56
Bead Breakers/Bead Breaker Pumps .....	57
Hydraulic Rams and Jacks .....	58
Ken-Tool Products .....	59-62
Ventrex Repair Systems .....	63
Ventrex Air Conditioning Valves .....	64
Notes .....	65-67
Haltec Part Number Index .....	68-69



## POLICY & WARRANTY

### PRODUCTS

Subject to change without notice. Haltec Corporation is not responsible for inadvertent typographical errors or omissions.

### RETURNED GOODS

No return goods will be accepted unless authorized in writing by Haltec Corporation. All return goods must be shipped prepaid to the factory, and are subject to a restocking charge. Special items are not returnable.

### SHIPMENTS

No minimum order is required.

### WARRANTY

Haltec Corporation, Salem, Ohio, warrants its tire valves and tire valve hardware to be free from defects in workmanship and materials for a period of 60 days from date of shipment from plant. Haltec will replace any item found to be defective, or, at its option, will refund the purchase price of such item, provided that notice of the defect is given by the buyer within 60 days from date of shipment. The foregoing warranty is in lieu of all other warranties, expressed or implied.

## SAFETY PRECAUTIONS

Tire and Rim Servicing can be dangerous, and should be done by trained personnel using proper tools and procedures. The Occupational Safety and Health Administration has a safety standard for the servicing of single-piece and multi-piece rim wheels (OSHA std 29 CFR 1910.177) to include requirements for the safe servicing of rims used on passenger, truck, trailers, buses and off-road vehicle equipment.

All tire servicing should be performed by persons trained properly. Haltec has copies of this safety standard available upon request. Ask for the standard entitled "Servicing Single-Piece and Multi-Piece Rim Wheels." Failure to comply with these procedures as well as procedures recommended by Tire Manufacturers and Wheel and Rim Manufacturers may result in faulty positioning of the tire and rim and cause the assembly to burst with explosive force sufficient to cause serious physical injury or death.

Haltec has developed a list of recommendations relating to the use of our products.

- 1) Prior to any tire work, the valve core should be removed to exhaust all air from the tire/wheel assembly.
- 2) Check the valve system by running a piece of wire through the stem to make sure it is not plugged. Tire/wheel assemblies are known to have contaminants in the assembly (dirt, dust, rust particles, etc.).
- 3) Use only tools which are recommended in the Tire Manufacturers and/or Rim Manufacturers catalog for the type of rim being serviced.
- 4) Use air servicing equipment that allows the person to stand outside the trajectory of the wheel and tire assembly.
- 5) Where a core housing (for tractor or Super Large Bore Valves) is involved, never loosen or attempt to remove the core housing until the air pressure is relieved.
- 6) When servicing an assembly with a core housing valve, use the proper inflation adapter for the intended service (310 Adapter for Tractor Service, CH-3 Core Housing, IN-80A for Super Large Bore, CH-8 or CH-16, Z12 for Z-Bore, MB-8 for Mega Bore.)



### T2001 Demounting Tool

Demounts both beads on most truck tires without the need for lifting the tire/wheel assembly off the ground, and then dropping it. See page 62.



### 001102 Alcoa Hub Kit

Light duty truck hub cover kit See page 56.



### 30230 Torque Wrench

Convert your own sockets into torque sockets for use on commercial, heavy-duty trucks, and buses. See page 62.

### 008222 Alcoa Hub Kit

Trucks, buses and trailers hub cover kit See page 56.

### Valve Stem Extension Stabilizer H-8864

Oblong fits 88364x+98364x, 2.50" off-center hole. See page 50.

### Valve Stem Extension Stabilizer H-8964

Oblong, fits prevost 89364, 2.00" off-center hole. See page 50.



H-8864



H-8964

New Products



### N-1418

- Effective Length 1 3/4"
  - Bend 74°
  - Shortest Large Bore Valve available
- See page 4.



### 70 MS-7

- Aluminum wheel valve with grommet seal.
  - Fits 9.7 mm
- See page 24.

TOLL FREE: 800-321-6471

www.halttec.com





**89TRL**  
Nitrogen Tire  
Inflation System  
See page 44.

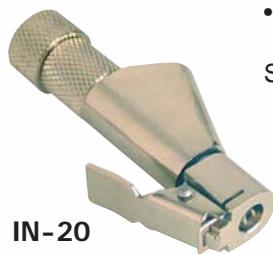

**IN-20**  
Core removing  
and inflator tool  
for cars  
See page 43.

**GA - 850-370**

Straight on with 180° reverse angle dual foot chuck  
(aluminum wheels)

- Guaranteed accurate to within 1 psi.
- LCD screen registers psi in .5 increments.
- Operates from 0 to 160 psi.
- Automatic shut-off prolongs battery life.
- Swivel fitting makes it easy to use.
- Available with CH-350-LO air chuck or CH-330-LO air chuck.

See page 36.



**GA-155S-RCL**

External adjustable screw allows the technician to re-calibrate according to onsite Master Test Gauge in order to maintain accurate pressure readings.

See page 34.



**GA-155-DG**

Dual foot air chuck allows easy access to inward valve. Digital screen displays in .5 psi increments.  
See page 34.

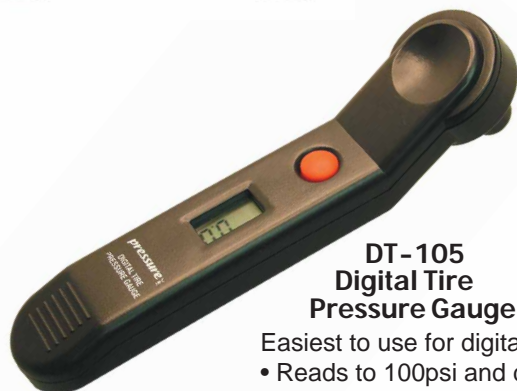

**DT-105**  
Digital Tire  
Pressure Gauge

Easiest to use for digital accuracy  
• Reads to 100psi and displays to .5 psi  
See page 36.



**8909-C**

Guides, aligns, and holds Large bore valve through rim hole while mounting the tire.  
See page 41.

**New Products**



## SINGLE BEND SWIVEL VALVES

- ◆ Any Other Lengths Can Be Ordered
- ◆ All Valves Equipped With Core And Hex Cap
- ◆ On Lengths Over 6", 2 Lock Nuts Are Furnished

ALL LARGE BORE SWIVEL VALVES CAN BE USED WITH ANY OF THE RIM SPUDS FEATURED ON PAGE 5.

Haltec No.	TR No.	Bend Angle	"L" Horiz. Length		"H" Vertical Height	
			Inches	MM	Inches	MM
N-1418	-	74°	1 3/4	44.5	1 5/64	27.4
WH-300-J-650	J-650	80°	3 1/8	79.4	1 5/64	27.4
WH-300-J-653	J-653	80°	2 1/2	63.5	1 5/64	27.4
WH-300-J-657	J-657	80°	4	101.6	1 5/64	27.4
WH-300-4 1/2	-	80°	4 1/2	114.3	1 5/64	27.4
WH-300-J-658	J-658	80°	5 1/2	139.7	1 5/64	27.4
WH-300-9	-	80°	9	228.6	1 5/64	27.4
WH-44-6	-	strt.	6	152.4	1 5/64	27.4
WH-45-2 1/2	J-4000-2 1/2	90°	2 1/2	63.5	1 5/64	27.4
WH-45-4	-	90°	4	101.6	1 5/64	27.4
WH-45-4 1/2	J-4000-4 1/2	90°	4 1/2	114.3	1 5/64	27.4
WH-45-5	-	90°	5	127.0	1 5/64	27.4
WH-45-6	J-4000-6	90°	6	152.4	1 5/64	27.4
WH-45-7 1/2	J-4000-7 1/2	90°	7 1/2	190.5	1 5/64	27.4
WH-45-8	-	90°	8	203.2	1 5/64	27.4
WH-45-9	J-4000-9	90°	9	228.6	1 5/64	27.4
WH-45-10	-	90°	10	254.0	1 5/64	27.4
WH-45-10 1/2	-	90°	10 1/2	266.7	1 5/64	27.4
WH-45-12	-	90°	12	304.8	1 5/64	27.4
WH-45-13	-	90°	13	330.2	1 5/64	27.4
WH-45-24	-	90°	24	609.6	1 5/64	27.4
WH-45-28	J-4000-28	90°	28	711.2	1 5/64	27.4
WH-45-29 1/2	J-4000-29 1/2	90°	29 1/2	749.3	1 5/64	27.4
WH-45-30	-	90°	30	762.0	1 5/64	27.4
WH-45-32	-	90°	32	812.8	1 5/64	27.4
WH-45-36	-	90°	36	914.4	1 5/64	27.4
WH-46-J-651	J-651	90°	4 11/16	119.0	1 17/64	27.4
WH-46-4 1/2	-	90°	4 1/2	114.3	1 17/64	27.4
WH-46-9	-	90°	9	228.6	1 17/64	27.4
WH-47-J-652	J-652	86°	5 1/2	139.7	1 5/64	27.4
WH-47-4 1/2	-	86°	4 1/2	114.3	1 5/64	27.4
WH-47-9	-	86°	9	228.6	1 5/64	27.4
WH-48-J-655	J-655	74°	3 1/8	79.4	1 5/64	27.4
WH-49-J-654	J-654	60°	3 1/8	79.4	1 5/64	27.4
WH-50-J-659	J-659	90°	3 1/2	88.9	1 57/64	50.4
WH-50-J-660	J-660	90°	8 3/4	222.3	1 57/64	50.4
WH-50-6	-	90°	6	152.4	1 57/64	50.4
WH-50-7 1/2	-	90°	7 1/2	190.5	1 57/64	50.4
WH-51-J-668	J-668	90°	4 11/16	119.0	5 1/8	130.2
WH-52-2	-	25°	2	50.8	1 5/64	27.0
WH-53-5 1/2	-	80°	5 1/2	139.7	1 21/64	33.8
WH-54-6	-	90°	6	152.4	2 25/64	60.8
WH-55-2 1/2	-	90°	2 1/2	63.5	2 25/64	60.8
WH-55-8 1/2	-	90°	8 1/2	216.2	2 25/64	60.8
WH-56-3	-	65°	3	76.2	1 5/64	27.4
WH-57-3	-	80°	3	76.2	1 5/64	27.4
WH-58-2 1/2	-	60°	2 1/2	63.5	2 1/8	54.0
WH-59-J-656	J-656	90°	3 11/16	93.7	2 5/8	66.7

# Large Bore Valve Systems

TOLL FREE: 800-321-6471

www.haltec.com



## DOUBLE BEND SWIVEL VALVES



Haltec No.	TR No.	Bend Angle	Horiz. Inches	Length MM	Vertical Inches	Height MM
WH-70-J-661	J-661	82°-8°	4 1/2	114.3	1 5/64	27.4
WH-70-J-661-10 1/2	-	82°-8°	10 1/2	266.7	1 5/64	27.4
WH-70-J-661-25 1/2	-	82°-8°	25 1/2	647.7	1 5/64	27.4
WH-70-J-661-28	-	82°-8°	28	711.2	1 5/64	27.4
WH-70-J-664	J-664	90°-13°	8 3/4*	222.3	1 5/64	27.4
WH-70-J-664-12 1/2	-	90°-13°	12 1/2*	317.5	1 5/64	27.4
WH-70-J-667	J-667	90°-11°	7 1/2*	190.5	1 5/64	27.4
WH-71-J-9	-	55°-35°	9	228.6	1 33/64	38.5
WH-72-J-21 1/4	-	70°-20°	21 1/4	539.8	1 5/64	27.4
WH-72-J-28	-	70°-20°	28	711.2	1 5/64	27.4
WH-73-J-21 1/4	-	60°-30°	21 1/4	539.8	1 3/8	34.9

\*Bent away from rim

## TRIPLE BEND SWIVEL VALVES



Haltec No.	TR No.	Bend Angle	Horiz. Inches	Length MM	Vertical Inches	Height MM
WH-75-J-662	J-662	90°-20°-20°	14	355.6	1 5/64	27.4
WH-75-J-662-10 1/2	-	90°-20°-20°	10 1/2	266.7	1 5/64	27.4
WH-75-J-663	J-663	90°-8°-8°	25	635.0	1 5/64	27.4
WH-75-J-665	J-665	90°-13°-13°	32	812.8	1 5/64	27.4
WH-75-J-666	J-666	84°-6°-31°-31°	20 1/8	511.2	1 5/64	27.4

- ◆ Any Other Lengths Can Be Ordered
- ◆ All Valves Equipped With Core And Hex Cap
- ◆ On Lengths Over 6", 2 Lock Nuts Are Furnished

**ALL LARGE BORE SWIVEL VALVES CAN BE USED WITH ANY OF THE RIM SPUDS FEATURED ON THIS PAGE!**

## RIM SPUDS

### H-41 Tubeless Spud (TR-SP-2)

Fits 13/16" rim hole. Used with all Large Bore Swivel valves.



### C-10 Large Bore Screw-in-Spud (TR-SP-3)

Screws into a 1/2" NPT-tapped hole in the rim. Can be replaced without dismounting tire.



### K-431 Clamp-in Type Spud

Installed from rim side for replacement without dismounting tire. Use #A-310, 5/16" Allen wrench to hold spud while installing. Do not use in continuous service. Temporary use only.



**Large Bore Valve Systems**

TOLL FREE: 800-321-6471

www.haltec.com



# Large Bore Valve Systems



## SPECIAL HYDROFLATING VALVES

- ◆ Designed for faster filling of tires with liquid. Does not contain valve core. Straight-through 5/16" opening is sealed with special O-ring cap No. A-151. Used on loader tire in conjunction with similar Large Bore Air Valve.

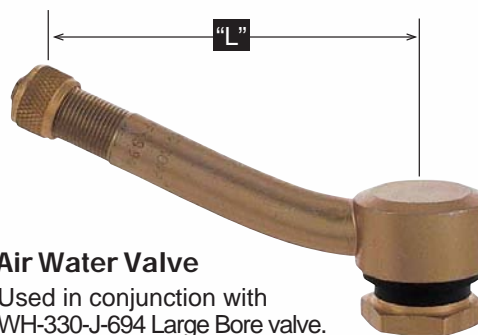

### Air Water Valve

Used in conjunction with WH-330-J-694 Large Bore valve.

Haltec No.	TR No.	Bend Angle	"L" Length		Cap
			Inches	MM	
WH-JF-994	JF-994	28°	3 1/2	88.9	A-151

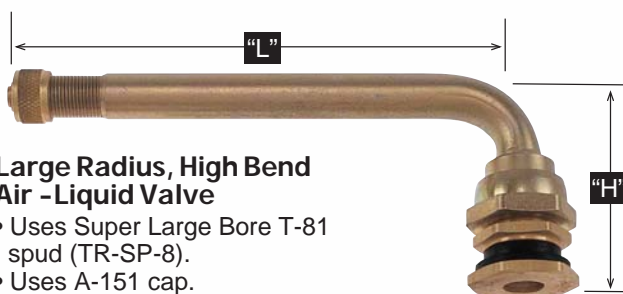

### Large Radius, High Bend Air -Liquid Valve

- Uses Super Large Bore T-81 spud (TR-SP-8).
- Uses A-151 cap.

Haltec No.	Bend Angle	"L" Length		"H" Height	
		Inches	MM	Inches	MM
977S-5 1/2	90°	5 1/2	139.7	2	50.8
977S-11	90°	11	279.4	2	50.8



### Large Radius, High Bend Air Valve Used with 977S

- All valves fit 13/16" valve hole.
- Uses A-145 valve core and A-149 cap

Haltec No.	Bend Angle	"L" Length		"H" Height	
		Inches	MM	Inches	MM
114S-5 1/2	90°	5 1/2	139.7	2	50.8
114S-11	90°	11	279.4	2	50.8

## TUBELESS TIRE REPAIR KIT

### RK-800 Off-Road Tubeless Tire Kit Consists of:

- RK-810** - Tire insertion tool (1)
- RK-820** - Tire material (1Box-50, 12" strips)
- RK-830** - Tire repair compound (8 oz.)
- RK-840** - Tire concentrated leak finder material (1)
- RK-850** - Tire concentrated leak finder applicator (1)

*Items can be ordered separately*



TOLL FREE: 800-321-6471

[www.haltec.com](http://www.haltec.com)



## TURRET VALVE FOR PLANETARY GEAR WHEELS

- ◆ All Valves Complete With Core ,  
Cap, Spud Nut and Grommet.

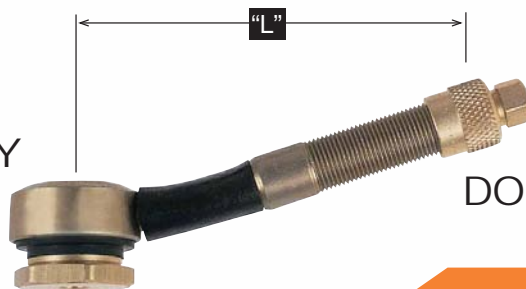

## DOUBLE SPUD VALVES

DS-385

For rims with valve hole  
counterbore on O.D. of  
rim.



Haltec No.	TR No.	Angle Bend 1	Off Set		Horiz. Length		Angle Bend 2
			Inches	MM	Inches	MM	
WH-330-J-690	J-690	28°	9/16	14.3	4 11/16	119.1	28°
*WH-330-J-691	J-691	18°	-	-	3 5/16	84.1	-
*WH-330-J-691B	J-691	18°	-	-	8 1/2	203.2	-
WH-330-J-692	J-692	28°	9/16	14.3	4 11/16	119.1	18°
WH-330-J-693	J-693	60°	1	25.4	5	127.0	60°
*WH-330-J-694	J-694	28°	-	-	3 1/2	88.9	-
WH-330-J-695	J-695	50°	1	25.4	4 1/8	104.8	50°
WH-330-J-696	J-696	42°	29/32	23.0	4 1/4	108.0	42°

\*Single bend

## DOUBLE SPUD VALVES



### DS-400-Length

This Large Bore double spud valve eliminates most of the plugging of Large Bore valves, which occurs at the bend of the swivel-type Large Bore valve.

**WH-44 Lengths Rigid Extension for Double Spud**  
Can be ordered in any length.



DS-390

For rims with 1/2" tapered  
pipe thread rim hole.

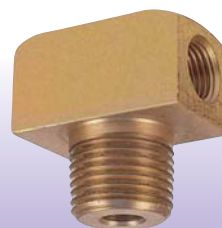

## LOADER TIRE VALVE

### T-670

Loader tire valve complete with core, hex cap and O-ring seal. Thread size is 1 1/16"-12.

Haltec No.	Height		Cap
	Inches	MM	
T-670	1 25/32	45.4	A-149



H-43

Double Spud plug



## TANK VALVE

### H-47

Screw-in type valve with 1/4" male pipe thread. Complete with core and cap.

Haltec No.	TR No.	Length	
		Inches	MM
H-47	J-671	1 19/32	40.5



TOLL FREE: 800-321-6471

www.haltec.com

Large Bore Valve Systems





# Large Bore Valve Systems

## STRAIGHT VALVES

### H-41

Tubeless spud, used with all Large Bore swivel valves. Fits 13/16" rim hole.

### H-42

Straight valve, equipped with core and hex cap.

### H-45

Spud and valve complete. Consists of H-41 & H-42.



Haltec No.	TR No.	Height	
		Inches	MM
H-41	SP-2	11/16	15.8
H-42	TRJ-670-2	1 1/2	38.1
H-45	TRJ-670-3	1 5/8	41.3



## EXTENSIONS

### Hand-Bendable

Equipped with 2 lock nuts and 3/4" hex sealing nut. A teflon gasket seals on end of valve, the lead seal in the sealing nut is forced into the threads for a second seal, positively locking extension to valve. Cap and core not included. They should be removed from valve and transferred to extension. Should be anchored to rim.

*Other lengths can be ordered.*

Haltec No.	Effective Length	
	Inches	MM
753S-3 1/2	3 1/2	89.6
753S-4	4	101.6
753S-4 1/2	4 1/2	114.3
753S-8	8	203.2
753S-9	9	228.6
753S-10	10	254.0
753S-11 1/2	11 1/2	292.1
753S-12	12	304.8
753S-13 1/2	13 1/2	342.9
753S-16	16	406.4
753S-17	17	431.8
753S-17 1/2	17 1/2	444.5
753S-18	18	457.2
753S-18 1/2	18 1/2	469.9
753S-19	19	482.6
753S-20 1/2	20 1/2	520.7
753S-21	21	533.4
753S-21 1/2	21 1/2	546.1
753S-22 1/2	22 1/2	571.5
753S-23	23	584.2
753S-23 1/2	23 1/2	596.9
753S-24 1/2	24 1/2	622.3
753S-25	25	635.3
753S-29 1/2	29 1/2	749.3
753S-32	32	812.8

TOLL FREE: 800-321-6471

[www.haltec.com](http://www.haltec.com)





Haltec No.	Effective Length	
	Inches	MM
867-1 1/4	1 1/4	31.8
867-1 1/2	1 1/2	38.1
867-2	2	50.8
867-2 1/2	2 1/2	63.5
867-3	3	76.2
867-3 3/8	3 3/8	85.7
867-4	4	101.6
867-4 1/2	4 1/2	114.3
867-5	5	127.0
867-5 9/16	5 9/16	141.3
867-6	6	152.5
867-6 7/8	6 7/8	174.6
867-7 1/4	7 1/4	184.2
867-7 3/4	7 3/4	196.8
867-8	8	203.2
867-8 1/2	8 1/2	216.2
867-9	9	228.6
867-10	10	254.0
867-10 3/4	10 3/4	273.0
867-12	12	304.8
867-12 1/2	12 1/2	317.5
867-16	16	406.4
867-18 7/8	18 7/8	479.4
867-22 1/2	22 1/2	571.5
867-24 1/2	24 1/2	622.3

## EXTENSIONS

### Rigid Brass

All-brass extension used where mounted in straight line with valve. Full-length deflector pin opens core in valve when servicing. Equipped with hex cap and 2 lock nuts on extensions over 5" in length. "Seal" is available (part #F-454).

*Other lengths can be ordered.*

Haltec No.	Effective Length	
	Inches	MM
810F-8	8	203.2
810F-9	9	228.6
810F-10	10	254.0
810F-11 1/2	11 1/2	292.1
810F-12	12	304.8
810F-13 1/2	13 1/2	342.9
810F-16	16	406.4
810F-17	17	431.8
810F-17 1/2	17 1/2	444.5
810F-18	18	457.2
810F-18 1/2	18 1/2	469.9
810F-19	19	482.6
810F-20 1/2	20 1/2	520.7
810F-21 1/2	21 1/2	546.1
810F-22 1/2	22 1/2	571.5
810F-23	23	584.2
810F-23 1/2	23 1/2	596.9
810F-24 1/2	24 1/2	622.3
810F-25	25	635.0
810F-29 1/2	29 1/2	749.3
810F-32	32	812.8
810F-40	40	1016.0

### Flexible

Made with tough rubber hose and reusable hydraulic-type fittings.

Equipped with 2 lock nuts and 3/4" hex sealing nut. A teflon gasket seals on end of valve. The lead seal in the sealing nut is forced into the threads for a second seal, positively locking extension to valve. Cap and core are not included. They should be removed from valve and transferred to extension.

*Other lengths can be ordered.*



Large Bore Valve Systems

TOLL FREE: 800-321-6471

www.haltec.com



# Large Bore Valve Systems

**CUSTOM-BENT  
SWIVEL VALVES  
AND EXTENSIONS  
FOR SPECIAL  
APPLICATIONS**

**LARGE BORE  
SCREW-ON  
VALVES FOR  
INNER TUBES**

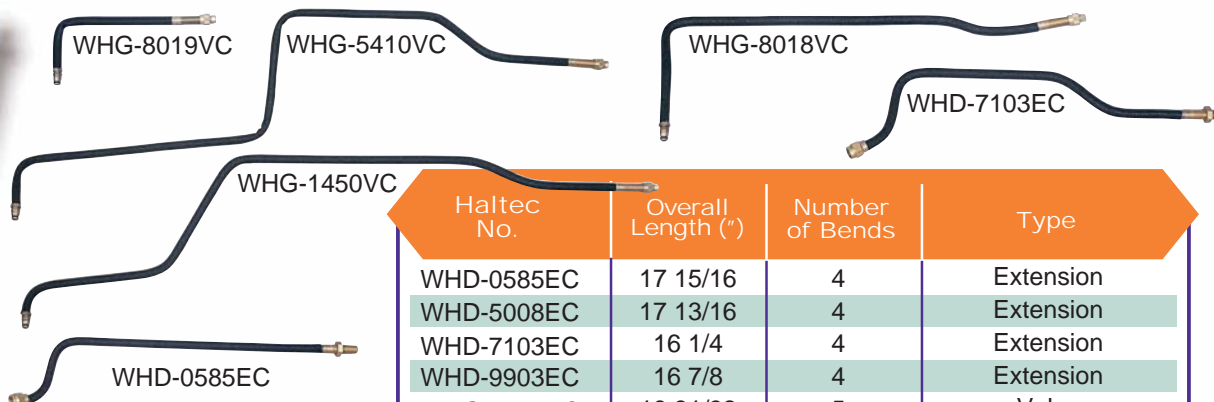

Haltec No.	Overall Length (")	Number of Bends	Type
WHD-0585EC	17 15/16	4	Extension
WHD-5008EC	17 13/16	4	Extension
WHD-7103EC	16 1/4	4	Extension
WHD-9903EC	16 7/8	4	Extension
WHG-0570VC	19 31/32	5	Valve
WHG-1450VC	32 7/8	5	Valve
WHG-4985VC	19 3/4	4	Valve
WHG-5200VC	27	5	Valve
WHG-5410VC	31 9/16	5	Valve
WHG-5420VC	33	5	Valve
WHG-8018VC	26 3/4	4	Valve
WHG-8019VC	8	1	Valve
WHG-9440VC	27	5	Valve
WHG-9470VC	31 1/2	5	Valve
WHG-5112VC	28 3/8	4	Valve
WHD-7601EC	16 3/4	4	Extension
WHD-7602EC	14 1/4	4	Extension
WHG-8852VC	18 9/16	4	Valve
WHD-5922EC	15 1/4	5	Extension
WHD-7940EC	19	5	Extension
WHD-7949EC	28 7/8	4	Extension

## H-4000 Adapter

H-4000 adapter converts tubes having SP-1000 type spud to accept Large Bore swivel valves. Equipped with BW-18 washer and used with rim slots.



## H-4000-1 Adapter

Same as H-4000 except without bridge washer and hex nut.

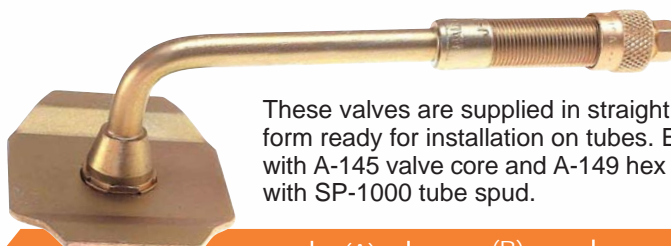

These valves are supplied in straight or bent form ready for installation on tubes. Equipped with A-145 valve core and A-149 hex cap. Used with SP-1000 tube spud.

Haltec No.	TR No.	(A) Angle Bend	(B) Vert. Height		(C) Horiz. Length	
			Inches	MM	Inches	MM
LB-216	J-1014	Strt.	1 29/32	48.4	-	-
LB-217	J-1076A	Strt.	4 5/32	105.6	-	-
LB-218	J-1076B	86°	1 1/8	28.6	3 1/4	82.6
LB-219	J-1076C	90°	1 1/2	38.1	2 7/8	73.0
LB-220	J-1076D	90°	2 1/16	52.4	2 5/16	58.7
LB-221	J-1076E	88°	1 3/8	34.9	3	76.2
LB-223	J-1175A	Strt.	5 9/32	134.1	-	-
LB-224	J-1175B	82°	1 1/4	31.8	4 1/4	108.0
LB-225	J-1175C	88°	1 3/8	34.9	4 1/8	104.8
LB-226	J-1078A	Strt.	5 25/32	146.8	-	-
LB-227	J-1078B	82°	1 3/8	34.9	4 5/8	117.5
LB-228	J-1078C	90°	1 1/8	28.6	4 7/8	123.8
LB-229	J-1179A	Strt.	6 13/32	162.7	-	-
LB-230	J-1179B	88°	1 3/8	34.9	5 1/4	133.4
LB-231	J-1179C	86°	1 3/8	28.6	5 1/2	139.7

**TOLL FREE: 800-321-6471**

**www.haltec.com**



## COMPONENTS OF THE HALTEC SUPER LARGE BORE SYSTEM



Super Large Bore Valve Systems



**M-1950 complete swivel valve, including  
R-520 core housing and T-81 spud**

### 2 Swivel Angle Connector



R-525

A-126

### 3 Flexible Extension

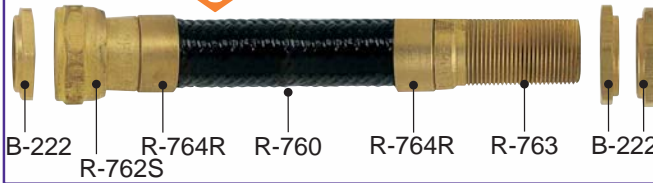

B-222

R-762S

R-764R

R-760

R-764R

R-763

B-222

### 4 Core Housing



A-127

R-520

### 1 Rim Spud



T-81

**M-1900, same as M-1950, but without T-81 spud**

## 1 CLAMP-IN SPUDS

### T-81 Clamp-In Spud

Fits the 13/16" diameter valve hole. The T-81 spud (TR-SP8) can attach any Super Large Bore valve to the rim through a standard valve hole (13/16" diameter). Tire must be dismantled to change spud.



### T-82 Clamp-In Spud

Similar to the T-81 spud but with an effective length 1/4" longer.



### K-665 Outside Clamp-In Super Large Bore

Can be changed without dismantling tire. Fits 13/16" rim hole. Use A-325 3/8" Allen wrench to hold spud while installing. Do not use in continuous service. Temporary use only.



## SCREW-IN SPUDS 1/2" NPT TAPPED HOLE

### C-100 Screw-In Spud C-155 Screw-In Spud

The screw-in spud is used to attach any of the Super Large Bore valves to the rim and is designed to screw into a 1/2" NPT-tapped rim hole. The spud can be changed without dismantling the tire. C-100 has internal thread for core housing. C-155 has no internal thread.



### S-85 Angle Screw-In Spud

S-85 angle screw-in spud. Fits 1/2" NPT-tapped rim hole. 85° bend angle. Other angles available.

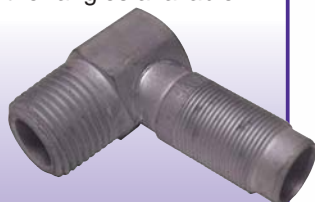

### S-85-D Angle Screw-In Spud

Furnished with a locking nut with a teflon seal so direction can be reversed. 85° bend angle.



TOLL FREE: 800-321-6471

www.haltec.com



# Super Large Bore Valve System



Component two of the Super Large Bore System is generally a swivel connector that screws on the spud.



Connectors of various angles and lengths are available.

The flow of the Large Bore valve is THREE times more air than the Standard Bore valve. The Super Large Bore valve is FOUR times more air than a Large Bore valve.

Measured in cost of down time and the cost to service large off-the-road tire, Super Large Bore is a bargain.

As the trend continues toward larger vehicles with larger tires, the need is for faster, more efficient tire servicing.

Super Large Bore fills that need. For even faster air flow, see the Mega Bore Valve System on page 20 or the Z-Bore on page 16.

2

## SWIVEL ANGLE CONNECTOR

Haltec No.	Bend Angle
R-525	90°
R-685	85°
R-625	80°
R-675	75°
R-660	60°
R-529 5 1/4"	90°

The other end of the connector accommodates a MT-3000 flexible extension which attaches to the R-520 core housing or the 6185 check valve

3

## MT-3000 Flexible Extensions Series

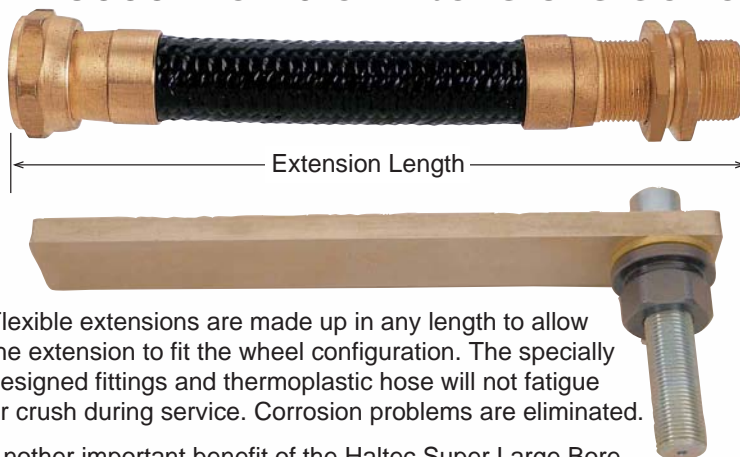

Flexible extensions are made up in any length to allow the extension to fit the wheel configuration. The specially designed fittings and thermoplastic hose will not fatigue or crush during service. Corrosion problems are eliminated.

Another important benefit of the Haltec Super Large Bore System is the ability to customize your extension in the field.

The R-969-K and R-969K-1 kits are available to field assemble your own flexible extensions with the T-620 assembly tool.

### Assembly Kit For Super Large Bore Valves Field Service

**R-969K-1** consists of R-762S swivel connector, R-763 straight tubing connector, R-764R (2) tubing connector sleeves and B-222 nuts (2).

**R-969-K** consists of the above plus the R-520 core housing complete with core and cap.

**R-760 Extension Tubing** - available in 50' and 100' lengths.

R-760



TOLL FREE: 800-321-6471

www.haltec.com



## 4 CORE HOUSING OR CHECK VALVE

### R-520 (TR-CH-8) Core Housing Complete with Core and Cap

The R-520 is designated at Tire and Rim as the CH-8. It is an integral part of the system as the CH-8 is removed from the valve assembly with the Haltec IN-80A adapter to utilize the larger opening and the fullest flow.



### 6185 (TR-L-860) Check Valve Complete with Cap

The 6185 design permits rapid inflation and deflation. Eliminates need for core housing and inflation adapter. Used with 6190 air chuck.



### 6190 Quick Connection Inflation Chuck

Designed specifically for use with 6185 check valve. Sliding sleeve locks air chuck onto check valve and permits unrestricted air flow. Gauging can be done through valve on chuck. Positive air line shut off valve must be installed in back of air chuck.



### WARNING SAFETY PRECAUTION

Products illustrated in this catalog, as well as all products supplied by Haltec, should never be used by persons unless they have been trained properly in the tire service according to O.S.H.A. Regulation #29CFR 1910.177 entitled "Servicing Single-Piece & Multi-Piece Rim Wheels." Haltec has available copies of this regulation upon request.

## 5 IN-80A SUPER LARGE BORE INFLATOR ADAPTER

The Haltec design of the Super Large Bore inflator adapter offers many advantages.

- 1/2" pipe thread for easy air hose connection. During inflation, air pressure in the tire can be checked through the stem knob with a tire pressure gauge.
- Reduces inflation time 60%, deflation time 80%.
- The core housing is held in a stainless steel extractor by a snap ring.
- Extrator is rugged enough so that the core housing can be loosened or tightened without being damaged.



Order G-327 kit to remove TV-CH-3 core housing, Large Bore and Standard Bore valve cores.

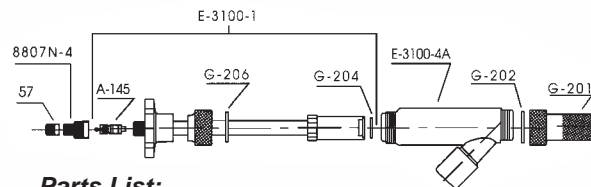

### Parts List:

- |                                   |                               |
|-----------------------------------|-------------------------------|
| ● G-201 Ejector Union             | ● G-202 Gasket for G-201      |
| ● E-3100-4A Adapter Body          | ● G-204 Snap Ring for Collet  |
| ● G-206 Gasket for E-3100-1       | ● A-145 Large Bore Valve Core |
| ● 8807N-4 Cap Adapter             | ● 57 Standard Bore Cap        |
| ● E-3100 Complete Stem and Collet |                               |

The IN-80A inflator adapter saves time by fast inflation or deflation on a tire. After removing the valve cap, the inflator is screwed onto the valve stem. The inflator stem is pushed in to engage the flats on the core housing. By rotating the stem counter clockwise, the core housing can be removed without any danger to the person removing it. The core housing is pulled up into the inflator body and held there during inflation or deflation. Can also be used for liquid-filling tires equipped with Super Large Bore valves.

TOLL FREE: 800-321-6471

www.haltec.com



Super Large Bore Valve Systems



## RIGID METAL SWIVEL VALVES

### MR-800 Swivel Valve

MR-800 Length. Rigid metal swivel valve with R-520 core housing and (2) B-222 lock nuts. **Can be ordered in different lengths.**



### MR-850 Swivel Valve

MR-850 Length. Same as MR-800 except with a T-81 rim stud.



### MR-890 Turret Valve

MR-890 Length. Rigid metal turret-type valve with R-520 core housing, B-222 lock nuts (3).



### M-2000 Swivel Valve Assembly

A 90° swivel valve having 3 1/8" horizontal length.



### Custom Valves

Custom valves can be formed with any bends and lengths to fit specific applications.

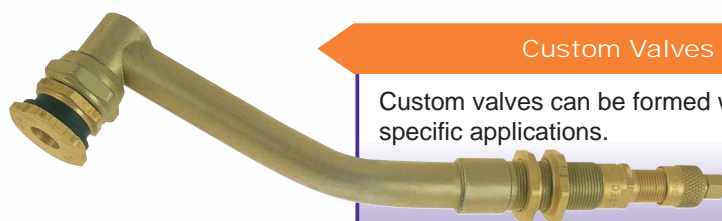

## DOUBLE SPUD ASSEMBLY

DS-210



DS-215



DS-210P



DS-226



### DS-296 Super Large Bore Double Spud Valve Assembly (with Flexible Extension)

Designed for wheels where space is critical. Valve height above rim is only 7/8". Consists of DS-210 double spud, DS-215 plug and MT-4000-length flexible extension.



### MT-4000 Length Flexible Extension

Used with DS-296 and PB-210. Any length can be ordered. Consisting of: DS-226 connector, R-763 connector, R-764R sleeves (2), R-760 tubing.

N -1538B

7 7/8" long super large bore turret valve with 15° bend, used on Caterpillar applications.



N -1543A

6 1/8" long super large bore turret valve with 15° bend, used on Caterpillar applications.



S-7910 Valve Support  
S-8860 Valve Support

S-7910 used for Super Large Bore.  
S-8860 used for Large Bore.



N-1066 Super Large Bore Loader Valve

Accepts R-520 core housing or other Super Large Bore swivel fittings. Thread size is 1 1/16"-12. Super Large Bore version of T-670.



M-5000 Valve Assembly  
Screw-in type spud with O-ring seal. R-521 core housings not interchangeable in other Super Large Bore spuds. Thread size is 3/4" - 16.

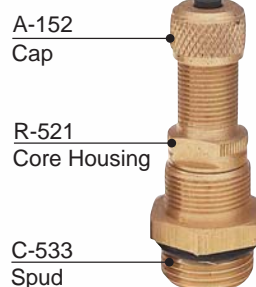

M-1870 Valve Assembly  
Super Large Bore straight valve assembly consists of R-520 core housing and T-81 spud.

N-1050 Valve Assembly  
Same as M-1870 but with T-82 spud.



SUPER LARGE  
BORE AIR-LIQUID  
VALVE FOR  
TRACTOR  
& GRADER

T-81 (SP-8)

Fits the 13/16" diameter rim hole.



H-50 (TR-F-910)  
Straight Valve Assembly

Components T-81 spud and R-372 core housing.



R-372 (CH-16)

Fits T-81, C-100 & TRSP 816 tube spud.



TOLL FREE: 800-321-6471

www.haltec.com

Super Large Bore Valve Systems





# Z-Bore Valve System

1

## RIM SPUDS



There are three spud types available: the standard clamp-in spud, a screw-in spud and an angle screw-in spud. There is no temporary outside-in clamp-in spud for Z-Bore.

The Z-Bore Valve System is very similar to the Super Large Bore System. By using an O-ring to seal the clamp-in spud to the rim, a greater flow diameter is created without sacrificing strength or performance.

***Z-Bore flows 370 CFM compared to 240 CFM on the Super Large Bore Valve System.***

### Z-2 Clamp-In Spud

Fits the 13/16" diameter valve hole. The Z-2 spud can attach any Z-Bore valve to the rim through a standard valve hole (13/16"). Tire must be dismounted to change spud.



### Z-1 Screw-In Spud

The screw-in spud is used to attach any of the Z-Bore valves to the rim and is designed to screw into a 1/2" NPT-tapped rim hole. The spud can be changed without demounting the tire.



### Z-13 Screw-In Spud

The Z-13 screw-in spud screws into the 3/4" NPT-tapped rim hole and converts Mega Bore to Z-Bore.



### Z-4 Angle Screw-In Spud

Fits 1/2" NPT-tapped rim hole. 85 degree bend angle.



2

## ANGLE CONNECTORS

The second component is the swivel angle connector which threads onto the spud. As with Super Large Bore valves, you can install a core housing into the spuds to make a valve.

### Angle Connector

Connectors of various angles and lengths are available. The connector accommodates a flexible extension which attaches to the Z-10 core housing.



Other Angles  
Available  
Upon Request.  
Use Z3 Angle

Haltec No.

Angle

Z3-75

75°

Z3-90

90°

Z3-80

80°

3

## THE Z-BORE FLEXIBLE EXTENSION CAN BE MADE UP IN VARIOUS LENGTHS

Flexible extensions are made up in any length to allow the extension to fit the wheel configuration. The specially designed fittings and thermoplastic hose will not fatigue or crush during service. Corrosion problems are eliminated. Another important benefit of the Haltec Z-Bore System



ZBFE-Length

is the ability to customize your extension in the field. The ZFAK field assembly kit is available to field assemble your own flexible extension with the Z-5 assembly tool.

TOLL FREE: 800-321-6471

[www.haltec.com](http://www.haltec.com)



## ZFAK - Assembly Kit for Z-Bore Valves

ZFAK consists of Z-8 Swivel connector, Z-7, straight tubing connector, two Z2-2 nuts, two Z-9 tubing connector sleeves and Z-10 core housing. Z-100 tubing is ordered separately.



The core housing is the final component. It contains a Large Bore valve core for servicing the tire assembly for routine pressure checks. The Z-12 inflator allows the complete removal of the core housing for the Z-Bore application.

4

Z-10 Core Housing  
Complete with Core and Cap

The Z-10 is an integral part of the system as the Z-10 is removed from the valve assembly with the Haltec Z-12 Inflator to utilize the larger opening and the fullest flow.

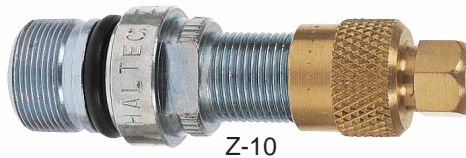

5

Z-12 Inflator

To maximize air flow, a Z-12 inflator is used to remove the core housing during inflation & deflation. This inflator operates like the IN-80A Super Large Bore inflator as seen on page 13.

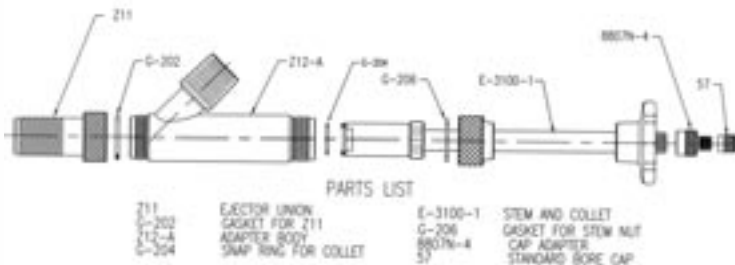
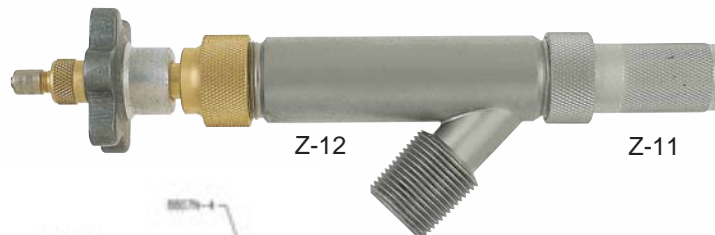

# Z-Bore Valve System



After fuel, tires are often a fleet's largest expense. The best way to insure maximum tire life is through proper tire inflation. Using a PT valve and gauge assembly, tire pressure monitoring has never been easier. Use the PT gauge for daily checks and a separate master gauge for weekly checks and you will prevent air loss before it can cause permanent tire damage.

A specially designed tire valve allows for constant visual pressure checks.

***In order to use PT gauge you must use a special PT tire valve.***

The PT valve hole allows the gauge to provide continuous pressure readings.

#### PT Gauge

The PT Valve System is a new design that allows tire pressure to be monitored with an easy-to-read, liquid filled, dial gauge attached to the valve.

PT gauge is ordered separately. Comes with gauge and nut. Calibrated 0-160 psi.



The PT valve and gauge can be used on most Large Bore and Super Large Bore applications.

*Patent Pending*

#### PTC Block-Off Collar

When the gauge is not being used, a PTC block-off collar can be installed to prevent air leakage. 5/8" hex.



#### PT-EX

Large Bore extension with 1 5/8" effective length to allow PT Gauge installation on existing valves.



#### PT-R-520

All PT valves have trouble-free, urethane O-rings on the valve barrel. For Super Large Bore applications, order the PT-R-520 core housing. Compatible for use with the IN-80A.



#### A-150 Cap

Valve cap used on PT-style valves. 5/8" hex.

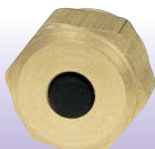

#### TL-634

Tightens nut to hold PT gauge on valve assembly. Also tightens A-150 cap and PTC collar.



PT Valve System

TOLL FREE: 800-321-6471

[www.haltec.com](http://www.haltec.com)

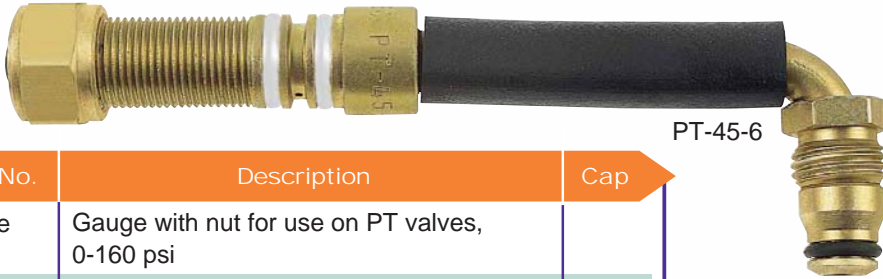

PT-45-6



PT-330-3 1/2

Haltec No.	Description	Cap
PT Gauge	Gauge with nut for use on PT valves, 0-160 psi	
PTC	Block-off collar for PT valves when gauge is not attached	
PT-300-J-650	WH-300-J-650 with PT grooves and O-rings	A-150
PT-45-6	WH-45-6 with PT grooves and O-rings	A-150
PT-330-J-690	WH-330-J-690 with PT grooves and O-rings	A-150
PT-H-42	H-42 with PT grooves and O-rings	A-150
PT-753S-6	753S-6 with PT grooves and O-rings	A-150
PT-R-520	R-520 with PT grooves and O-rings for Super Large Bore	A-150
PT-330-3 1/2	Turret-style valve with 3 1/2" effective length	A-150



- OTHER VALVES AND SIZES AVAILABLE
- TO ORDER OTHER VALVES ADD THE PREFIX "PT" TO THE HALTEC VALVE NUMBER
- ASSEMBLE THE VALVE TO THE TIRE AND WHEEL ASSEMBLY BEFORE INSTALLING THE PT GAUGE TO THE PT VALVE.

This gauge mounts on specially designed PT-style valves which allow visual tire pressure checks yet also allows for inflation, deflation and manual pressure checks without removing the gauge.

The PT gauge has an all-anodized aluminum body and is totally sealed to prevent moisture from fogging the glow-in-the-dark dial.

The PT Gauge is liquid filled to prevent damage from vibration.

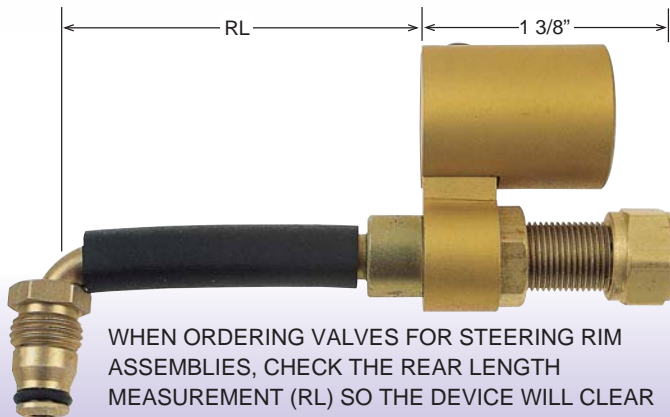

WHEN ORDERING VALVES FOR STEERING RIM ASSEMBLIES, CHECK THE REAR LENGTH MEASUREMENT (RL) SO THE DEVICE WILL CLEAR THE VALVE LUG. THIS IS IMPORTANT ON SOME FRONT TRUCK RIMS AND REAR FORKLIFT OR CONTAINER MOVER TIRES.

PT Valve System





# Mega Bore Valve System

## MB-13 Valve Cap

Cap for the Mega Bore core housing. Protects core housing from damage. Has an O-ring seal.



## MB-25 Hex Cap

Cap for the Mega Bore core housing. Protects core housing from damage. Has an O-ring seal. Has modified Hex that can be installed or removed using the TL-700.



## MB-20 Clamp-In Spud

Fits a 15/16" diameter valve hole. Tire must be dismantled to change spud. Attach any Mega Bore angle connector to the MB-20 spud.



## MB-26 Screw-In Spud

Fits a 3/4" NPT threaded valve hole, screw-in spud. Attach any Mega Bore angle connector to the MB-26 spud. Spud can be changed without disconnecting tire.



## MB-12-85 & MB-12-75 Screw-In Angle Spud

The screw-in spud is used on a 3/4" tapped rim hole. Attaches to a MB-14 rigid or a FMB flexible Mega Bore valve. The spud can be changed without dismantling the tire.



## MB-19-85 & MB-19-75 Angle Connectors

An angle connector screws onto the MB-20 spud. The other end of the connector accommodates a MB-14 rigid valve or a FMB flexible Mega Bore valve.



## MB-29-85 Angle Connectors

An angle connector screws onto the MB-20 spud. The other end of the connector accommodates a MB-27 rigid valve or Caterpillar O-ring face seal hydraulic hose.



## MB-27 Face Seal Mega Bore Valve

Rigid Mega Bore valve can be screwed onto MB-29 angle connector or Caterpillar O-ring face seal hydraulic fittings.



## MB-14 Rigid Mega Bore Valve

Rigid Mega Bore valve can be screwed into any Mega Bore angle connector or screw-in spud.



**The following must be used to maximize the airflow characteristics of the Mega Bore Valve System:**

A 3/4" NPT-tapped rim hole or a 15/16" dia. rim hole.  
3/4" air line to the compressor with a minimum diameter through all fittings of 11/16".

Air compressor capable of 100 cfm (minimum) with a line pressure 30 psi above the desired tire inflation pressure.  
Use of the MB-8 Mega Bore inflator.

TOLL FREE: 800-321-6471

[www.halttec.com](http://www.halttec.com)

### FMB Length Mega Bore Flexible Valve



Screws into the Mega Bore angle connectors or screw-in angle spud. Can be made up in any length (minimum 8"). The specially designed fittings and thermoplastic hose will not crush or fatigue during service. Large Bore threads on the core housing allow use of Large Bore pressure gauges and air chucks.

### MBV-L



Screws into the Mega Bore angle connectors or screw-in angle spud. Made to length in the field using the MBAT assembly tool. MB-14 screws into the end to complete the valve.

### TL-700 Tool



The TL-700 fits the Mega Bore core housing to retract the housing for inflation and deflation. The TL-700 should be used only in conjunction with the MB-8 Mega Bore inflator. The MB-8 inflator should be engaged on the core housing before using the TL-700.

### MB-8 Inflator

The MB-8 Mega Bore inflator attaches to the valve body by turning the knurled nut on the inflator in a clockwise direction. The 3/4" ball valve is used to open and close the air flow after the core housing is retracted with the TL-700.



### Components for Mega Bore Flexible Valve Field Assembly



MBAT Assembly Tool



R-761 Tubing



MB-5A



MB-3



MB-23



## STANDARD AND ARCTIC O-RINGS FOR TUBELESS RIMS

### Haltec O-Rings

- Packaged 2 per poly bag
- 24 O-rings per case
- Sold in case lots
- Consistent product quality
- Manufactured of high-quality material
- O-rings individually marked in an easy-to-read color
- Manufactured to major OEM specifications
- Spliced O-ring with exceptional splice strength
- Extruded product allows diameter variation to meet the wide variety of rim O-ring grooves, both domestic and foreign
- Two compounds for all service conditions:  
Standard -40° to 180°F  
Arctic -65° to 180°F
- Customized product available for special applications

Haltec No.	Tire Type	Rim Size	Rod Diameter
OR-21-T	Highway	21"	.26
OR-25-T	Earthmover	25"	
OR-20-JM	Highway (JM Rim)	20"	
OR-22-JM	Highway (JM Rim)	22"	
OR-24-JM	Highway (JM Rim)	24"	.28
OR-215-H	Grader	15"	
OR-217-L	Grader	17"	.26
OR-220-TG	Grader	20"	
OR-224-TG	Grader	24"	.375
OR-225-T	Grader	25"	
OR-321-T	Earthmover	21"	
OR-325-T	Earthmover	25"	
OR-329-T	Earthmover	29"	.5
OR-333-T	Earthmover	33"	
OR-335-T	Earthmover	35"	
OR-339-T	Earthmover	39"	
OR-343-T	Earthmover	43"	
OR-345-T	Earthmover	45"	
OR-349-T	Earthmover	49"	
OR-449-T	Earthmover	49"	
OR-451-T	Earthmover	51"	
OR-457-T	Earthmover	57"	
OR-463-T	Earthmover	63"	
OR-469-T	Earthmover	69"	

## L-RING SEALS FOR EARTHMOVER RIMS

### Proper Use of Haltec L-Ring Seals

The primary purpose of the L-ring seal is to create an air seal where the tire bead and rim bead seat are not completely compatible. Some of the examples where the L-seal will prove useful:

- Where you have an irregular butt weld in the knurled bead seat area.
- Where, during initial inflation, the bead seating is very difficult.
- When an air passage between the bead and the rim is identified.
- Where overloads and severe operating conditions cause the rim deformation (deflection) which can result in air leakage.

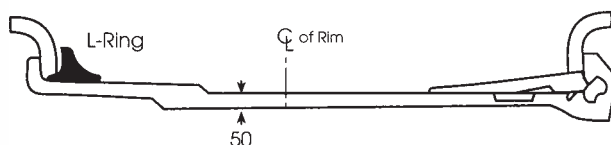

### Important Information

- L-Ring Seals are not a cure for damaged beads nor damaged wheels and rims. Caution should be used during all fitments. Do not install where broken bead is suspected.
- Always follow the respective manufacturers' recommendation for proper bead-lubrication and initial air pressure to properly seat beads.
- If you have any questions regarding the use of the L-ring seals, contact Haltec prior to attempting any installation.

Haltec No.	Description
LR-25	25" L-ring seal
LR-29	29" L-ring seal
LR-33	33" L-ring seal
LR-35	35" L-ring seal
LR-39	39" L-ring seal
LR-45	45" L-ring seal
LR-49	49" L-ring seal
LR-51	51" L-ring seal
LR-57	57" L-ring seal
LR-63	63" L-ring seal
LR-69	69" L-ring seal



## TRUCK AND BUS VALVES

Haltec No.	TR Number	Effective Length
TV-500	500	2"
TV-501	501	1 1/2"
TV-570	570	3 1/8"
TV-571	571	3 3/8"
TV-572	572	3 3/4"
TV-573	573	4 3/8"
TV-574	574	5"
TV-575	575	1 1/8"

Straight clamp-in valves used on both demountable and non-demountable rims. For .625" diameter valve hole.

**Available in BENT FORM**

### METRIC RIM HOLE VALVE (9.7MM VALVE HOLE)

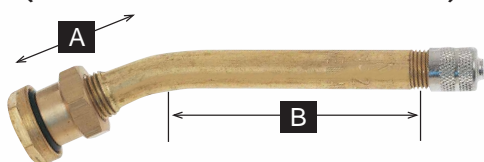

Some imported trucks will have steel wheels that incorporate the 9.7mm valve hole (.390"). These are the most popular valves for this application.

Haltec No.	ETRTO	Bend	A Height	B Height
60 MS-27	No ETRTO	27°	1 3/16"	1 3/16"
70 MS-27	V3-20-5	27°	1 3/16"	1 9/16"
80 MS-27	V3-20-7	27°	1 3/16"	2"
90 MS-27	V3-20-4	27°	1 3/16"	2 3/8"
115 MS-27	V3-20-6	27°	1 3/16"	3 3/8"
41 MS-00	V3-20-1	STR	1 3/16"	-

**Other sizes available upon request.**

### TRUCK VALVES FOR ALCOA ALUMINUM TRUCK WHEELS

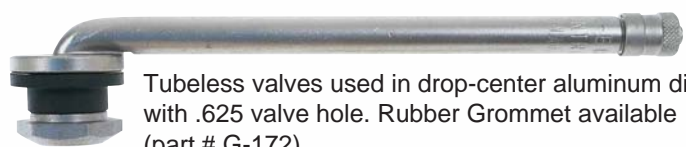

Tubeless valves used in drop-center aluminum disc wheels with .625 valve hole. Rubber Grommet available (part # G-172).

Haltec No.	TR No.	Bend Angle	E.L.
TV-509	TR-509	90°	4 3/4"
TV-510	TR-510	90°	5 1/2"
TV-511	TR-511	90°	4 1/4"

#### TV-417 Clamp-in Valve (TR417)

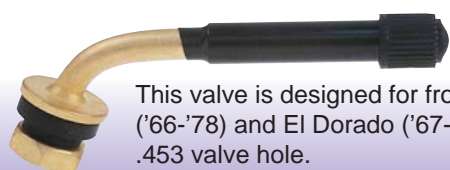

This valve is designed for front-wheel drive Toronado ('66-'78) and El Dorado ('67-'78) cars. .453 valve hole.



#### TV-430 Tubeless Motorcycle Valve

Has O-ring seal, fits .327" valve holes. Effective length is 1 3/16".



#### TV-575-HP

Low profile with 1" E.L. Has grommets to fit either .453 or .625 diameter valve hole.



#### TV-6008C Tractor Front Wheel Valve

Low profile valve offers minimum protrusion above the rim. 9/16" effective length with chrome finish. Fits .453 or .625 valve hole.

#### TV-6008

Same as above except brass finish.



#### H-523MS Alloy Valve

A light alloy valve used on racing and light alloy wheels. Fits .453 valve hole and has O-ring seal.



Truck And Bus Valves



TV-542



TV-543E



TV-543D



TV-543



70 MS-7

- Aluminum wheel valve with grommet seal.
- Fits 9.7 mm



## O-RING SEAL VALVES FOR ALCOA TRUCK WHEELS (9.7MM VALVE HOLE)

Haltec No.	Valve TR No.	A Height	Bend Angle	B Length	Hex Nut
TV-542	542	1.25	-	-	HN-22
TV-543	543	2.4	-	-	HN-22
TV-543C	543C	.93	45°	1.43	HN-22
TV-543D	543D	.98	60°	1.38	HN-22
TV-543E	543E	.98	75°	1.38	HN-22
TV-544	544	2.9	-	-	HN-22
TV-544C	544C	.98	45°	1.94	HN-22
TV-544D	544D	.98	60°	1.94	HN-22
TV-545	545	3.5	-	-	HN-22
TV-545D	545D	.98	60°	2.6	HN-22
TV-545E	545E	.98	75°	2.6	HN-22
TV-546	546	4.25	-	-	HN-22
TV-546D	546D	.98	60°	3.35	HN-22
TV-546E	546E	.98	75°	3.35	HN-22
TV-547D	547D	.98	60°	3.78	HN-22
TV-546-36	546-36	.98	36°	3.35	HN-22

## VALVES FOR FORD TRUCKS

TV-575HP/DS-1

- Ford "Cut-Away" and Cargo Van Series with Single Rear Wheels
- Accuride Steel 16" x 7" Wheels
- Front & Rear Wheels
- Chrome Finish



TV-416LF

- Ford "Cut-Away" Series with Dual Wheels
- Accuride Steel 16" x 16" Wheels
- Front & Rear Wheels
- Nickle Finish



TV-416/DS-1

- Ford "F" Series Trucks with Dual Wheels
- Accuride Steel 19.5"
- Front & Rear Wheels
- Nickle Finish



N-1600

- Ford "F" Series Trucks with Dual Wheels
- Alcoa Aluminum 16"
- Front & Rear Wheels
- Chrome Finish



TV-416MC

- Ford "F" Series Trucks with Dual Wheels
- Accuride Steel 16" x 16"
- Front & Rear Wheels
- Nickle Finish



Truck And Bus Valves

TOLL FREE: 800-321-6471

www.haltec.com

## H-5010V Valve for 16 x 6 KS Wheel With Oval Valve Hole

Circumferential rim slot for valve for 16 x 6KS and 16 x 6 1/2LS rim contours.

Design allows a positive seal in this special valve hole. We recommend checking the valve hole for metal burrs prior to installation. Grommet is not replaceable.

## Double Bend Valves

For tubeless truck and bus tires. Extra-low vertical height clamp-in type. Fits .625" valve hole.

Haltec No.	TR No.	Effective Length
TV-513	513	2 5/8"
TV-515	515	3 1/4"

Haltec No.	TR No.	Effective Length	Valve Hole
TV-416	416	1 1/4"	.453 or .625
TV-416L	-	2"	both grommets furnished

## High-Pressure Tubeless Tire Valve

Used to 100 psi cold inflation pressure. Fits .625" or .453" diameter valve hole, maximum rim thickness .205" at valve hole.

Haltec No.	TR No.	Effective Length	Valve Hole
TV-600-HP	600HP	1 1/4"	.453
TV-602-HP	602HP	2"	.453
TV-801-HP	801HP	1 1/4"	.625
TV-802-HP	802HP	2"	.625

Haltec No.	TR No.	Effective Length	Valve Hole
TV-412	412	7/8"	.453
TV-413	413	1 1/4"	.453
TV-414	414	1 1/2"	.453
TV-415	415	1 1/4"	.625
TV-418	418	2"	.453
TV-423	423	2 1/2"	.453
TV-425	425	2"	.625
TV-413-CH	Chrome	1 1/4"	.453
TV-418-CH	Chrome	2"	.453

## Einky Valves

A high-performance "No Show" type chrome plated valve that installs from the outside. A rubber washer and nut are on the inside.

Haltec No.	Bend Angle	Effective Length	Valve Hole
TV-6010	STR.	3/4"	.453
TV-6020	45°	-	.453
TV-6030	STR.	1 1/4"	.453
TV-6040	STR.	1 3/4"	.453



TV-515

N-1147

## Radial Commander Valve N-1147 for 15" Disc Wheels

23° bend clamp-down valve for .625 valve hole. Bend allows clearance of brake drum for tire service.



TV-416

## Clamp-in Valve

Used on car and light truck applications. Maximum inflation pressure 130 psi.



TV-801-HP and TV-802-HP designed for use with transporting mobile homes.

## Snap-In Tire Valve & Chrome Sleeve Tire Valves

Maximum cold inflation pressure 65 psi.



Cars, Lt. Truck & Misc. Valves





## TRUCK VALVE EXTENSIONS



### HE-370 Series Light-Weight Extensions

Series has the short collar for use on tube-type or tubeless valves. Available in 2"-3"-4" and 5" effective lengths. Has a double seal feature to assure a positive seal.

### HE-390 Series Light-Weight Extensions

Light-weight extensions are the same as above except with a long collar.

### HE-380 Series Straight Metal Extensions

These screw on the standard valve stem (.305-32 cap thread) and make the valve mouth accessible for service.



Haltec No.	Description	Collar Type	Effective Length
HE-370	Truck Extension	Short 3/8"	2"
HE-371	Truck Extension	Short 3/8"	2 15/16"
HE-372	Truck Extension	Short 3/8"	3 15/16"
HE-373	Truck Extension	Short 3/8"	5 1/8"
HE-389	Truck Extension	Long 1"	1 1/16"
HE-390	Truck Extension	Long 1"	2"
HE-391	Truck Extension	Long 1"	2 15/16"
HE4430	Truck Extension	Long 1"	4"
HE-392	Truck Extension	Long 1"	5 1/8"
HE-393	Truck Extension	Long 1"	6"
HE-394	Truck Extension	Long 1"	8.0"
HE-395	Truck Extension	Long 1"	10.0"
HE-396	Truck Extension	Long 1"	12.0"
HE-397	Truck Extension	Long 1"	14.0"
Standard Style	-	-	-
HE-381	Truck Extension	Long 1"	3 1/16"
HE-382	Truck Extension	Long 1"	5 1/16"
HE-383	Truck Extension	Long 1"	6 1/16"

## ALCOA STABILIZER & EXTENSION KIT

Proper air pressure is the most important factor in lengthening tire life. On dual wheel assemblies, the inner dual is many times overlooked or improperly serviced. The Alcoa Extension and Stabilizer Kit allows access to the inner dual tire valve and properly positions and supports the extension for servicing. The stabilizer reduces the road vibration on the extension and practically eliminates valve stem breakage caused by vibration.

**Available in 9 sizes.**  
**Each stabilizer kit contains**  
**2 stabilizers and 2 extensions.**

### STABILIZER & EXTENSION KIT



Haltec No.	Fits Alcoa Wheel Size	Diameter Hand Hole	Hole Position
H-2125	19.5"	1.50"	Center
H-2126	19.5"	1.50"	Off-Center
H-2127	22.5 x 9.0	1.50"	Center
H-2225	22.5"	2.00"	Center
H-2245	24.5"	2.19"	Off-Center
H-2246	Peterbilt	Oval	Center
H-2227	22.5"	2.50"	Center
H-2247	24.5"	2.375"	Off-Center
H-2257	Freightliner 19.5"	Custom	Center
H-8864	22.5" & 24.5	2.50"	Off-Center
H-8964	Prevost	2.00"	Off-Center

Haltec No.	Stabilizer (2)	Extensions (2)
125392	H-2125	HE-392
126392	H-2126	HE-392
127393	H-2127	HE-393
225392	H-2225	HE-392
227392	H-2227	HE-392
245392	H-2245	HE-392
246392	H-2246	HE-392
247392	H-2247	HE-392
257392	H-2257	HE-392

Valve Extensions

TOLL FREE: 800-321-6471

www.haltec.com



## PLASTIC VALVE EXTENSIONS

### HE-350 Black Polymer Extensions

These light-weight truck extensions are made of a durable, tough plastic able to withstand the conditions tire valve extensions are exposed to, yet they are extremely lightweight. Designed for use where vibration and weight is a concern for valve stem breakage.



## BENT EXTENSIONS FOR STANDARD BORE VALVES

Haltec No.	Bend	Effective Length	Vertical Length
HE-200	90°	1 3/8"	3/4"
HE-201	45°	1 3/8"	3/4"
HE-202	135°	1 3/8"	15/16"



## SCREW-ON REPAIR VALVES

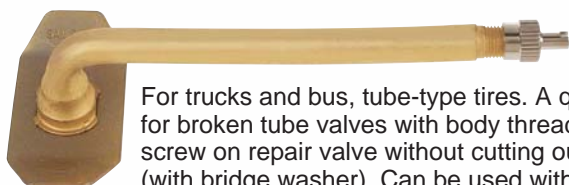

For trucks and bus, tube-type tires. A quick replacement for broken tube valves with body thread. Cut off valve and screw on repair valve without cutting out old valve base. (with bridge washer). Can be used with SP-1000 tube spud.

Haltec No.	TR No.	Effective Length
RV-1177A	1177A	3 1/4"
RV-1077A	1077A	4 1/8"
RV-1175A	1175A	4 1/2"
RV-1078A	1078A	5"
RV-1179A	1179A	5 5/8"

## DOUBLE SEAL CAP

DS-1

This double seal valve cap seals at the top of the cap which prevents dirt and water from penetrating the cap, eliminating the chances of clogged air passages due to ice and debris. Allows for inflation and deflation of the tire without removing the cap. A great time saver.



## DUAL WHEEL FLEXIBLE VALVE EXTENSIONS

### FE-300 Length

This extension provides easy access to the inner dual tire found on campers, recreational vehicles and light trucks. Fits standard valve cap threads. Comes with clamp to secure extension to wheel cut-out. 2 extensions per pack. Standard effective lengths are 7" and 9".

Other lengths available upon request.

### SFE-400 Length

Similar to the FE-300 series except has steel braided hose. Available in 7" and 10" lengths only.

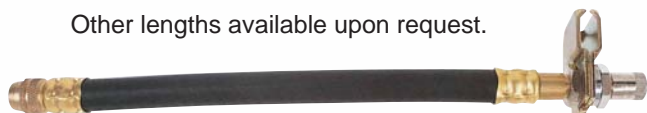

TOLL FREE: 800-321-6471

www.haltec.com

Valve Extensions



## HIGH-PRESSURE SHOCK STRUT VALVES

Constructed of stainless steel bodies for use in high-pressure shock absorber units, hydraulic pressure accumulators, surge cylinders and high-pressure pneumatic systems. Valves have 1/2" - 20 U.N.F. - 3A threads for connection to container.



**H-7607  
Shock Strut Valve**  
For operating pressure  
to 2,000 psi.  
Conforms to AN-812-1.



**H-4361  
Shock Strut Valve**  
For operating pressure  
to 3,000 psi.  
Conforms to AN-6287-1.



**H-798  
Shock Strut Valve**  
For use on shock struts  
where operating pressure  
is rated for 5,000 psi.  
Conforms to MS-28889-2.

## HIGH-PRESSURE INFLATING CONNECTIONS

These high-pressure inflating connections attach securely by hand or wrench to the valve cap threads of high-pressure valves.



**H-556  
High-pressure  
inflating connection**  
Fits .305-32" thread size  
with 1/8" NPT male connection.  
Has core depressor pin,  
and copper sealing washer.  
Maximum working  
pressure 3000 psi.

**H-2755  
High-pressure  
inflating connection**  
Fits .305-32" thread size  
with 3/8"-24 thread for  
3/16" flare tube fitting,  
meets MS336556E3. Has  
core depressor pin and copper  
sealing washer. Maximum  
working pressure 3000 psi.



**H-6116B  
High-pressure  
inflating connection**  
Fits .305-32" thread size  
with 1/8" NPT female  
connection with 70° bend.  
Equipped with hard fiber  
sealing washer.  
Used up to 3000 psi  
working pressure.

**H-6116**  
Same as H-6116B except  
has straight extension.



**5007**  
Fits .305-32" thread size  
with 7/16"-20 thread for  
1/4" flare tube fitting.  
Meets MS 33656E4.  
Maximum pressure rating  
is 15,000 psi. Recommended  
torque 75 in/lb for steel valves.  
Has copper sealing washer.





## TANK VALVES

Utilized on pressure containers where gauging or servicing may be required. Tank valves are used with various gases, fluids and operating pressures. For specific application, please contact Haltec for technical assistance.

Haltec No.	OAL	Base Thread	Cap Thread	Hex Size
TV-399	1 5/16"	1/8" NPT	.305-32	7/16"
TV-400	1 5/16"	1/4" NPT	.305-32	9/16"
TV-401	27/32"	1/8" NPT	.305-32	7/16"
TV-402	1 5/16"	1/8" NPT	.305-32	7/16"
H-47	1 19/32"	1/4" NPT	.482-26	9/16"



## THERMOCOUPLE CONNECTION FOR TIRE TESTING

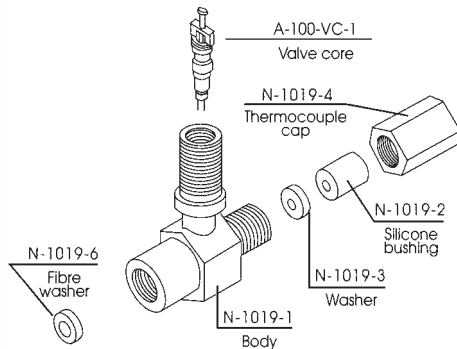

### N-1019

Allows the testing facility to monitor internal temperature of the tire.

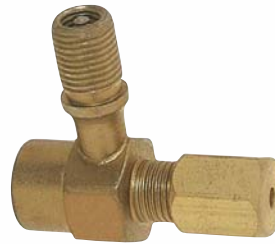

## RADIAL TIRE BEAD SEATERS

One-piece rubber tube for mounting hard-to-seat radial, bias belted or conventional truck tires. As tire is inflated, the lubricated bead seater forms a seal between the rim and tire allowing the air pressure to force the beads into the rim flange. As proper pressure is reached, the bead seater slides out and over the rim.

### For truck tires:

TC-50 for 16.5" and 17.5" Rims

TC-60 for 19.5" Rims

TC-70 for 22.5" and 24.5" Rims

### For passenger tires:

PC-1 for 13" Rims

PC-2 for 14" and 15" Rims

PC-3 for 15" Rims

PC-4 for 17" Rims

PC-5 for 18" Rims

**Note:** O.S.H.A. Regulations require that service personnel use a clip-on air chuck with an inline inflator at a recommended distance that keeps the employee out of the trajectory of the tire and rim. After beads are seated, put tire and rim into approved inflation cage and continue to inflate to prescribed air pressure.



**Rim Guard HX-44**  
Protective cover for aluminum and chrome bolt hole areas while using an impact wrench.



**Wheel Shield HX-24**  
Protective cover for aluminum and chrome wheels. Snaps into place. Shows proper torque sequence numbers for wheel nuts.

TOLL FREE: 800-321-6471

www.haltec.com

Special Application Products



Valve assemblies with removable core housing for liquid fill. Has Vulc-on back to allow field repair.



## AIR/LIQUID EXTENSION



### TV-5905 Air/Liquid Extension

Used with tractor or grader valve stems. 90 degree angle for more accessible valve.

See pages 37 & 38 for Service Tools for Air Liquid Valves

## AIR LIQUID VALVES FOR TRACTOR AND ROAD GRADER SERVICE

Haltec No.	TR No.	A	B	Bend Angle	Valve Hole
TV-618A	TR-618A	1 7/8"	-	-	.625
TV-618B	TR-618B	1 1/2"	-	-	.625
TV-621A	TR-621A	1 1/2"	3	65°	.625
TV-622A	TR-622A	1 3/4"	4 1/2	90°	.625
TV-623A	TR-623A	1 1/2"	2 1/4	65°	.625
N-1000	TR-619A	1 7/8"	-	-	.812
H-50	TR-F910B	1 13/16"	-	-	.812

## TRACTOR AND GRADER TUBE

Haltec No.	TR No.	Base Diameter	Core Housing	Vertical Height	Valve Hole
TV-218R	TR-218A	2 1/2"	TV-CH-3	1 7/8"	.625
TV-220R	TR-220A	2 1/2"	TV-CH-3	2 15/16"	.625
TV-916R	TR-916A	3 1/4"	R-372	1 7/8"	.812

## RIM HOLE PLUGS

### P-15 for Tube-Type Wheels

Used to plug 5/8" rim hole and avoid tube "pouching."



### N-1012S

Used to seal 5/8" rim hole when relocating valve.



### T-30

Used to seal 13/16" rim hole when relocating valve.



### ALSP

Air-liquid spud plug. Used to replace CH-3 core housing.



## CORE HOUSINGS

### TV-CH-1

Fits old-style TR-218 and TR-220 valves.



### TV-CH-3

Fits all fast flow air-liquid valves except Super Large Bore.



### R-372/TR-CH-16

Fits SP816 tube spud and T-81 & C-100 spud.



## RIM NUTS AND BUSHINGS



**LN-10 Plastic Rim Nut**  
Rim nut for tractor tube valves TR-218A and TR-220A. **For brass rim nut, order LN-10B.** See page 38 for TL-LN-10 installation tool.



**B9A Bushing Assembly**  
Fits over TR-218A and TR-220A valves to allow use of valve in the 13/16" valve hole. Consists of B9 bushing and LN-13 nut.



**B-6 Bushing**  
Fits over TR-13 tube valve when used in 5/8" valve hole.



## 310 Valve Adapter Gun

Has a 1/2" female pipe thread and will attach to any calcium tire filling pump, it will extract the valve core from a Standard Bore valve or the core housing from a tractor valve. It will securely hold the valve core or core housing up in the gun

body during tire filling or evacuation of liquid from a tire. Due to the design, it will permit faster evacuation of liquid from a tire than with other adapter guns. Replaces Deming #1010.

### Parts List

- FP-134 Large Bore Core Remover
- FP-135 Adapter for Standard Valve (Equipped with FP-136)
- FP-136 O-Ring for FP-135 Adapter
- FP-137 Standard Valve Core Remover
- FP-138 Ejector Union (Equipped with FP-146)
- FP-139 Gasket
- FP-140 Stem
- FP-141F Adapter Body
- FP-142 Stem Sealing Nut
- FP-143 O-Ring for FP-142 (Stem Seal)
- FP-144 Hand Wheel
- FP-145 Lock Nut
- FP-146 Teflon Gasket

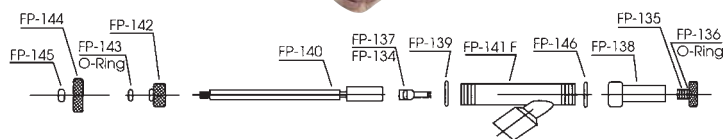

### Aqua Quick Fill Haltec

#### AQF-1 Patent No. 5.007.448

Haltec's Aqua Quick Fill is a simple, time-saving tool that allows the user to fill a tractor tire or large off-the-road tire with liquid, and do other tasks while the tire is being filled. No longer does the user have to stand by and vent the excess air pressure. With the AQF-1, air is automatically vented through a side port while the liquid is being injected into the tire. When the tire is filled, the water escapes from the vent hole, indicating that the tire is full.



### Fluid Connectors

#### Coupler N-1451

1/2 NPT female thread. Designed specifically for fluid use.



#### Nipple N-1452

1/2 NPT male thread.

For fluid use.



### Water Adapter

#### N-1091 For liquid fill tires



N-1091-2



N-1091-3

#### N-1057

Flexible extension for 310 gun.



## 307 Urethane Fill Adapter

With Plastic Valve Plugs for Urethane Tire Filling Pumps

Attaches directly to the urethane pump discharge hose with a 1/2" female pipe thread. An adapter bushing is provided to attach the gun union to a standard size tire valve. By removing the adapter bushing, the union can be attached to a tractor-type valve (TR-218A), a grader valve (TR-618A), or any Large Bore valve (TR-650).

Delrin plugs are used to seal the valve after the tire is filled with urethane up to the desired pressure. The plugs are self-threaded into the valve by pushing in the hand wheel and turning clockwise. This permanently seals the valve and the adapter can be removed immediately. This is a much more positive method of sealing a tire that has been filled with urethane.

### Parts List

- FP-135 Adapter for Standard Valve (Equipped with FP-136)
- FP-136 O-Ring for FP-135 Adapter
- FP-138 Valve Stem & Ejector Union (Equipped with FP-146)
- FP-139 Rubber Gasket
- FP-141A Adapter Body
- FP-142 Stem Sealing Nut
- FP-143 O-Ring for FP-142 (Stem Seal)
- FP-144 Hand Wheel
- FP-145 Hex Lock Nut
- FP-146 Teflon Gasket
- FP-153 Collet Adapter for Standard Valve Plug
- FP-154 Stem & Collet
- FP-155 Snap Ring for FP-153
- FP-156 Snap Ring for FP-154
- P-250 Standard Valve Delrin Plug
- P-251 Tractor & Grader Valve Delrin Plug
- P-252 Large Bore Valve Delrin Plug

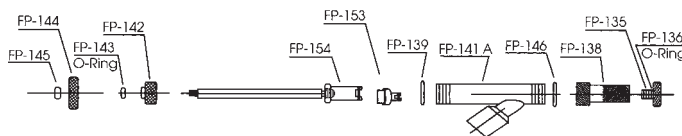





# Valve Cores, Caps & Adapters

A-145



A-144

A-100-VC-1



## VALVE CORES

Tire & Rim No.	Haltec No.	Description
C-1	A-100-VC-1	Standard Bore Heat-Resistant Core for Cars, Trucks and Busses.
C-2	A-145	Large Bore Core (short). Fits 305-32 Threads
C-2	A-144	Large Bore Core (long). Fits 305-32 Threads



DS-1



A-100-VC-2



A-100-VC-3



A-100-VC-8



A-100-VC-8G



N-1202

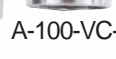

A-100-VC-12

## VALVE CAPS (STANDARD BORE)

Tire & Rim No.	Haltec No.	Description
-	DS-1	Double Seal Valve Cap
VC-2	A-100-VC-2	Metal Screwdriver Valve Cap for Removing Valve Cores
VC-3	A-100-VC-3	Metal Dome Valve Cap
VC-8	A-100-VC-8	Plastic Dome Valve Cap
VC-8	A-100-VC-8G	Plastic Green Dome Valve Cap
-	A-100-VC-12	Heavy-Duty Dome Cap for Truck Service. Has Heat-Resistant Sealing Washer.
-	N-1202	Chrome-Plated Hex Cap



A-147



A-148



A-149



A-151



8807N-3

## VALVE CAPS (LARGE BORE)

Tire & Rim No.	Haltec No.	Description
VC-6	A-148	Screwdriver Valve Cap. Fits .482-26 Valve Threads.
VC-7	A-149	Hex Valve Cap for Easy Tightening and Removing with Wrench. Fits .482-26 Valve Cap
A-10	A-147	Dome Cap
VC-4	8807N-3	Screwdriver Cap for 8807N-4 and AD-1 Adapters
-	A-150	Large Bore Short Hex Cap
-	A-151	Used Only with Hydro Inflating Valves. See page 6
VC-10	A-152	Large Bore Short Dome Cap
	N-1135	Large Bore Deflating Cap

## VALVE ADAPTERS

AD-1

Adapts Large Bore valve down to Standard Bore. Fits in 305-32 valve core threads.



8807N-4

Adapts Large Bore valve down to Standard Bore. Fits in .485-26 valve cap threads.



TOLL FREE: 800-321-6471

www.haltec.com

## DUAL FOOT TRUCK SERVICE GAUGE

Haltec offers a wide variety of service gauges to accommodate the numerous tire and wheel configurations encountered by the service personnel. Choose the gauge that best fits your particular needs.

GA-155-DG



**NEW**

GA-135



GA-140 Master Test Gauge



GA-165



GA-155



Gauge #	Calibration	Incre.	Bar	Chuck Style	Finish
GA-135	10-150 PSI	2 PSI	Nylon	Angled Chuck	Chrome
GA-135S	10-150 PSI	2 PSI	Metal	Angled Chuck	Chrome
GA-135-ADJ**	10-150 PSI	2 PSI	Metal	Angled Chuck	Chrome
GA-155	10-150 PSI	2 PSI	Nylon	Straight-on 30° Reverse	Chrome
GA-155-DG	10-150 PSI	2 PSI	Nylon	Straight-on 30° Reverse	Chrome
GA-155S	10-150 PSI	2 PSI	Metal	Straight-on 30° Reverse	Chrome
GA-155S-RCL**	10-150 PSI	2 PSI	Metal	Straight-on 30° Reverse	Chrome
GA-155-ADJ**	10-150 PSI	2 PSI	Metal	Straight-on 30° Reverse	Chrome
GA-165*	10-150 PSI	2 PSI	Nylon	Straight-on 30° Reverse	Black Polyurethane
GA-175*	10-150 PSI	2 PSI	Nylon	Angled Chuck	Black Polyurethane
GA-140	10-160 PSI	2 PSI	Nylon	Angled Chuck	Chrome/Poly
GA-185	10-150 PSI	2 PSI	Nylon	Straight-on 180° Reverse	Chrome
GA-185S	10-150 PSI	2 PSI	Metal	Straight-on 180° Reverse	Chrome

\*Extended head design for easier engagement to the valve. \*\*Recalibratable

### GA-185

This gauge has a special 180° reverse chuck to accommodate the small hand holes found on many of today's truck wheels.



GA-185

## DUAL FOOT TRUCK HIGH-PRESSURE GAUGE

GA-130



GA-150



GA-160



Gauge #	Calibration	Increments	Bar	Chuck Style	Finish
GA-130	20-120 PSI	2 PSI	Nylon	Angled Chuck	Chrome
GA-150	20-120 PSI	2 PSI	Nylon	Straight-on 30° Reverse	Chrome
GA-160*	20-120 PSI	2 PSI	Nylon	Straight-on 30° Reverse	Black Polyurethane
GA-170*	20-120 PSI	2 PSI	Nylon	Angled Chuck	Black Polyurethane

\*Extended head design for easier engagement to the valve.

## TIRE GAUGE GRIP

### TGG-1 Tire Gauge Grip

Allows a positive grip on your gauge during inclement weather conditions and serves as a protective cushion should the gauge be inadvertently dropped. Can be used on all dual foot truck service gauges.





## GROMMETS

Tire & Rim No.	Haltec No.	Fits	Used On
RG-7	G-166	.625 Valve Hole	TV-618, 621A, 622A, 623A
RG-15	G-170	.625 Valve Hole	TV-500 Series, TV-570 Series
RG-16	G-162	.812 Valve Hole	Turret Valves, PB-210, H-1000
RG-22	G-160	.812 Valve Hole	H-41, T-81, T-30, DS-385, DS210
RG-46	G-172	.625 Valve Hole	TV-509, 510, 511
RG-48	G-174	.625 Valve Hole	TV-513, 515
-	G-165	.812 Valve Hole	K-431, K-665
-	G-170S	.625 Valve Hole	Heat-Resistant Grommet for TV-570 Series
RG-54	5976-5	.453 Valve Hole	TV-416, 416L, 6008
RG-39	5976-6	.625 Valve Hole	TV-416, 416L

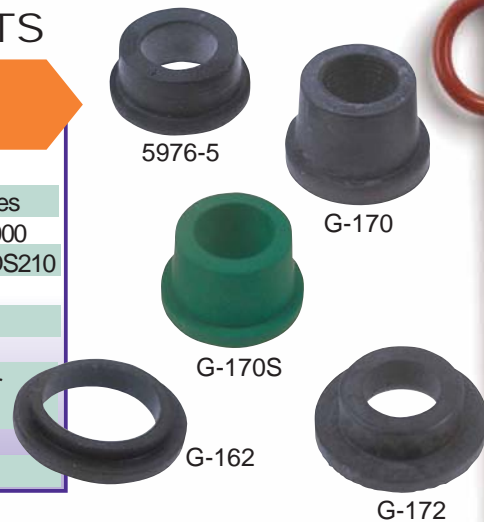

## HEX NUTS

Tire & Rim No.	Haltec No.	Fits	Used On
HN-1	464	.485-26	L.B. Valves, 753S, 810F, 867, TV-618A, 621A, 622A, 623A
HN-2	LN-1		FE-300 Series
HN-13	10071	.406-26	TV-500 Series, TV-570
HN-15	451	11/16-16	H-41, T-30
HN-17	HN-17	.406-28	TV-509, 510, 511
HN-18	HN-18	.406-28	TV-513, 515
HN-21	HN-21		TV-540 Series
HN-80	B-222	11/16-24	M-1900, M-1950, H-4000 MR-800, MR-850, T-81
LN-13	B9-2		B9A Assembly
-	452	11/16-24	K-431
-	463	.485-26	753S, 810F (Jam Nut)
HN-22	HN-22	-	H-543C, TV-540 Series



## WASHERS

Tire & Rim No.	Haltec No.	Fits	Used On
-	453	11/16-24	K-431, K-665
RW-8	10058	.406-28	TV-500 Series, TV-570 Series
RW-11	W-1101-1	.485-26	TV-618A, TV-621A, 622A, 623A



## O-RINGS

Tire & Rim No.	Haltec No.	Used On
-	A-126	R-762S, R-525 & SLB Angle Connections
-	A-127	R-520, R-372, R-521
-	0-320	Swivel Valves, H-43, H-42
-	10008	T-670
-	10009	M-5000
RG-30	0-330L	TR-540 Series Valves
-	A-128	DS-215, DS-226



TOLL FREE: 800-321-6471

www.haltec.com

Grommets, Hex Nuts, Washers & O-Rings



## PENCIL TIRE GAUGES



GA-125



GA-146

Haltec Pencil-Type Tire Pressure Gauges have a highly polished finish with an easy-to-read, 4-sided nylon indicating bar and a handy pocket clip.

NOTE: All pencil gauges have a chuck guide to assure gauge fits squarely on the tire valve. This prevents air leakage and guarantees accurate pressure readings.

Gauge #	Calibration	Increments	Bar	Service	Finish
GA-100	1-20 PSI	1/2 PSI	Nylon	Garden Tractors	Chrome
GA-105	10-50 PSI	1 PSI	Nylon	Passenger Tire	Chrome
GA-110M	10-50 PSI/73-325 kPa	1 PSI	Nylon	Passenger Tire	Chrome
GA-115	20-120 PSI	2 PSI	Nylon	Truck High Pressure	Chrome
GA-120M	20-120 PSI/150-800 kPa	2 PSI	Nylon	Truck High Pressure	Chrome
GA-125	5-45 PSI	1 PSI	Nylon	Air-Liquid Tires	Chrome
GA-145	10-75 PSI/70-500 kPa	1 PSI	Nylon	Radial & Spare Tire	Chrome
GA-146	20-90 PSI	1 PSI	Nylon	Radial & Light Truck	Chrome

### GA-100-DIS

Colorful display of 10 gauges of our GA-100 model

### GA-105-DIS

Colorful display of 10 gauges of our GA-105 model

### GA-115-DIS

Colorful display of 10 gauges of our GA-115 model

**Personalized Gauges Available. Call For Details.  
1-800-321-6471**



### N-1420H Truck Tread Depth Gauge

- Calibrated in millimeters and 1/32nds of an inch.
- Measures shoulder wear as well as tread depth.
- Durable metal construction, chrome-plated.
- Comes in a clear protective plastic pouch.
- Can be custom imprinted.
- Pocket-size.



### GA-190 Tire Tread Depth Gauge

Quickly and accurately measures how much tread is left on tire. Calibrated in 1/32" units and millimeters. Chrome-plated brass with pocket clip.

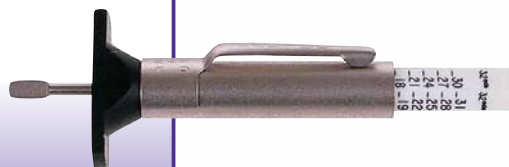

**TOLL FREE: 800-321-6471**

**www.haltec.com**

**Service Gauges**



## TIRE INFLATION COMPRESSORS 89-COM



VENTREX



### *Semi-Comfort System*

The Ventrex Semi-Comfort Tire Repair System is the fastest and easiest way to repair tires and eliminate slow leaks. The system automatically injects the sealant into the tire and then inflates to the desired PSI. No Mess! The Semi-Comfort system also comes complete with the required adapters to inflate the tire.

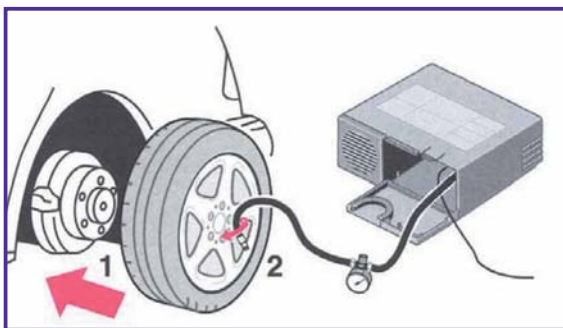

OPTION 1

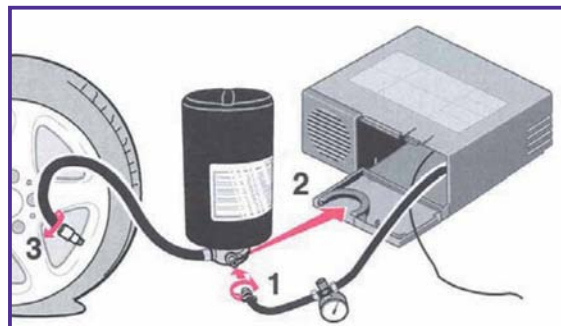

OPTION 2

TOLL FREE: 800-321-6471

[www.halttec.com](http://www.halttec.com)

Ventrex Repair Systems



# Digital & Dial Gauges



## DIGITAL AIR GAUGES

Haltec No.	Operating Range	Increments (psi)	Application
GA-850-330	0-160	.5	Standard Bore air gauge w/CH-330 dual foot air chuck
GA-850-350	0-160	.5	Standard Bore air gauge w/CH-350 dual foot air chuck
GA-850-370	0-160	.5	Standard Bore air gauge w/CH-370 dual foot air chuck
DT-105	0-100	.5	Standard Bore digital air gauge



## DIAL AIR GAUGES

Haltec No.	Operating Range	Increments (psi)	Description
GA-274	0-160	5	14" Standard & Large Bore Air Liquid Gauge
GA-276	0-160	5	18" Standard & Large Bore Gauge w/Extension Handle & bleeder valve
GA-290	0-160	1	12" Standard & Large Bore Air Master Gauge equipped with recalibration feature
N-1055	0-160	5	12" Standard Bore Air Gauge; equipped with an CH-335 dual foot air chuck
GA-285	0-160	5	10" Dial Gauge with Rigid Extension
GA-289	0-160	5	Replacement Dial Gauge
N-1510	0-160	5	Cap Gauge; screws onto Large Bore & Super Large Bore valves for inspection of tire pressure

TOLL FREE: 800-321-6471

[www.haltec.com](http://www.haltec.com)



## LARGE BORE GAUGES



### GA-240 Straight Pencil Gauge

Straight-on chuck fits Standard and Large Bore valves. Calibrated 20-120 psi in 2 lb. increments. Furnished with pocket clip.



### GA-250 High Pressure Gauge

10-150 lbs. in 3 lb. units. For Standard and Large Bore valves. Has nylon indicating bar and Haltec Posi-Seal washer.

### GA-250S

Same as above with metal indicating bar.



### GA-255 Large Bore Swivel Foot Gauge

Quality Features:

Nickel-plated brass

Nylon slide bar. Easy to read.

Calibrated 10-150 in 2 lb. units

Swivels 360° for those hard-to-reach valves. Haltec Posi-Seal washer.

### GA-255S

Same as above with metal indicating bar.

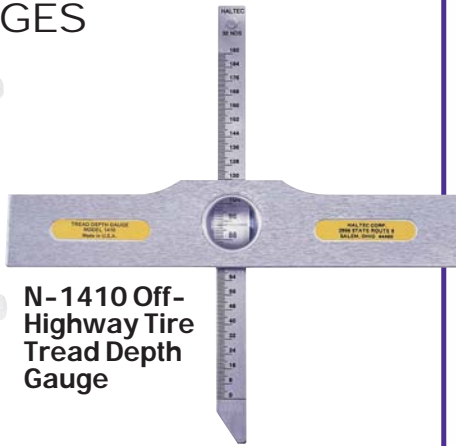

### N-1410 Off-Highway Tire Tread Depth Gauge

Indicating bar is calibrated with 32nds on one side, other side is millimeters. Has magnified sight-glass for easy readability. Comes with a carrying holster. The finest instrument available.



### 5131 - Large Bore Tread Depth Gauge

Two piece gauge made up of slide tube and indicator. Calibrated 0-6" in 1/32" units and 7 to 152 mm metric. Tubing spans tread lugs on off-road tires.

### TL-680 Three-Way Large Bore Tool

For removing large bore cores, hex caps and screw driver caps.

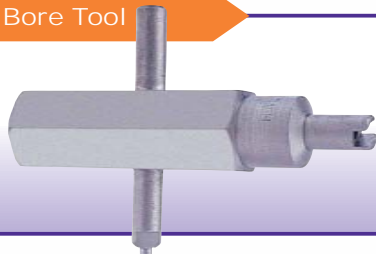

### TL-690 Four-Way Large Bore Core Tool

Thread repair for core and cap threads and core remover. For Large Bore and Super Large Bore.

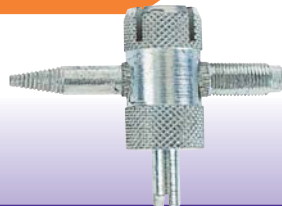

### TL-695

The TL-695 is a four-way tool that repairs the internal and external threads on air-liquid valve spuds. It also is a Large Bore valve core insertion tool, and it repairs internal and external threads.



## LARGE BORE TOOLS



### ASP-10 Deflation Aspirator

Tube deflation aspirator for Large Bore.

TOLL FREE: 800-321-6471

www.haltec.com

Large Bore Gauges, Service Tools & Chucks



## LARGE BORE TOOLS



**N-1610 Large Bore Core Tool**



**N-1710 Large Bore Core Tool**

Special valve core screwdriver tool. Sliding sleeve allows positive grip on valve core for those hard-to-reach valves.



**N-1810 Large Bore Hex Cap Remover**

With plastic handle for positive grip - OAL 10".



**N-1910 Large Bore Core Remover**

Has plastic handle for positive grip - OAL 6".



**TL-631 Super Large Bore Rethreading Tool**

Used to rethread 11/16" - 24 thread on any Super Large Bore valve.



**TL-LN-10**

The TL-LN-10 is a nut driver that installs the LN-10 nut onto the TV-218A/TV-220A tractor tire valve.



**322 Large Bore Dual Foot Air Chuck**

45° angle chuck allows easy access to the tire valve. Has 1/4" NPT female thread.



**326 Screw-On Air Chuck**

Has .485-26 internal thread and 1/2" NPT external thread. Full flow for seating of tire beads.



**377 Lock-On Air Chuck (Long)**

Chuck locks on valve when cocked on threads. Has greater air flow and seat cannot be blown out if seal fails. Has 1/4" NPT female thread.

**328 Lock-On Air Chuck (Short)**

Chuck locks on valve when cocked on threads. Has greater air flow and seat cannot be blown out if seal fails. Has 1/4" NPT female thread.

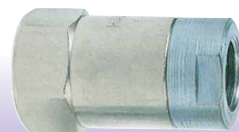

**H-4660A Clip-On Air Chuck**

Securely locks onto valve when sleeve is pushed forward, releases when sleeve is pulled back. Has 1/4" NPT female thread.



**10013 Large Bore Screw-On Chuck**

Fits 3/8" ID air hose. Screws on to Large Bore valves. Open and close the valve core by turning the knob on top of the chuck.



**6190 Quick-Connection Inflation Chuck**

Designed specifically for use with 6185 check valve. Sliding sleeve locks air chuck onto check valve and permits unrestricted air flow. Gauging can be done through valve on chuck. Positive air line shut off valve must be installed in back of air chuck.





#### CH-315 Ball Foot Air Chuck with Clip

3/4" hex, with 1/4" NPT female thread. Heavy-duty spring firmly holds chuck onto valve while inflating tire.

Available for use with tire changers.

**Order CH-315-OP.**



#### CH-340 Lock-On Air Chuck

Securely locks onto valve when sleeve is pushed forward. Releases when sleeve is pulled back. 1/4" NPT female thread.

Available for use with tire changers.

**Order CH-340-OP.**



#### CH-305 Ball Foot Air Chuck

3/4" hex, brass with 1/4" NPT female thread.

Available for use with tire changers.

**Order CH-305-OP.**



#### H-5265

The H-5265 is a specially designed air chuck that locks onto the cap threads of a Standard Bore valve stem when the sliding sleeve is pushed to the forward position. The chuck releases when the sleeve is pulled back. Available for use with tire changers. **Order H-5265 OP.**



#### CH-318 Chuck Clip

For CH-315 and CH-315-OP.



## EUROPEAN-STYLE CLIP-ON AIR CHUCKS

#### CH-320

Very similar to our N-1200 European-style clip-on air chuck. This is a closed-type chuck and offers the best seal available. Has serrated shank for 1/4" I.D. hose.



#### N-1199 N-1200



**N-1199** fits 3/16" hose.



**N-1200** fits 1/4" I.D. hose-open style.

#### CH-360

This new chuck features the popular European-style clip with a brass 1/4" female fitting. Compact, durable and easy to use, this chuck is available either closed (**CH-360**) or open (**CH-360-OP**). Made in the USA.

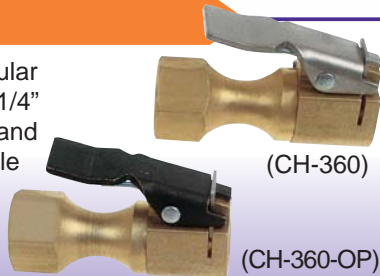

(CH-360)

(CH-360-OP)

TOLL FREE: 800-321-6471

www.halttec.com

Standard Bore Air Chucks





# Standard Bore Air Chucks

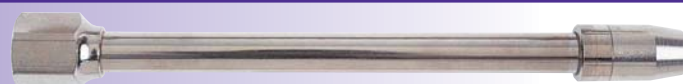

## CH-300

The Haltec CH-300 Lock-On Air Chuck with a small head design makes for easy access to hard-to-reach valves on inside dual wheels. The extended head design improves the lock-on feature. Has 1/4" NPT female threads.



## CH-330-LO Dual Foot Air Chucks

Straight-on 30° reverse angle chuck. Available with the lock-on feature. Has 1/4" NPT female thread. 6" long.

**CH-330 Dual Foot Air Chucks:** Same as CH-330-LO (above) except without lock-on feature.



## CH-335-Dual Foot Air Chuck

Dual foot for hard-to-reach tractor, dual wheel trucks and bus tires. 1/4" NPT female threads. For standard air line service. 6" long.



## CH-350-LO

A new design offers greater durability and is more user friendly on the straight-on and 30° reverse angle chuck. This 6" -long chuck finished with an attractive black polyurethane coating has 1/4" NPT female threads.

## CH-333-LO

Similar to CH-330-LO but with extra long length of 14".



## CH-355-LO

Similar to CH-350-LO but with extra long length of 14".



## CH-370-LO

A special air chuck with a straight-on connection and a 180° reverse angle chuck allows easier access to valves located in tight, hard-to-reach places. The CH-370-LO is 6" long and has 1/4" female threads.



## SHUR-LOCK VALVE CORE TOOLS

Haltec No.	Description	Length
TL-132	Valve Core Tool for Cars	1 3/4"
TL-133	Valve Core Tool for Trucks	8 1/4"
TL-134	Valve Core Tool for Large Bore Cores	10 1/2"

A special design allows the valve core to stay attached to the tool after it is removed from the valve. A great tool to keep the valve core from getting dropped or lost. TL-133 Uses flexible shaft for hard to reach valves.



TOLL FREE: 800-321-6471

[www.haltec.com](http://www.haltec.com)

### TL-612 Standard Bore Core Tool

With an overall length of 8" and oversized handle, the Haltec TL-612 provides a firm grip for inserting and removing valve cores.



### TL-620 Standard Bore Core Tool

Plastic handle provides firm grip for inserting and removing valve core.



### TL-625 Standard Bore Valve Core Tool

How many times have you pushed the valve core tool through your pocket? Here's a tool with a recessed probe that fits easily in any pocket.



### TL-630 Hex Nut Driver For 500 Series Truck Valves

Installation tool for tubeless clamp-in metal valves. Accommodates all lengths of tubeless truck valves including the TV-574.



### TL-632 Truck Extension Service Tool

This tool tightens both metric (European) and domestic type extensions. This tool is broached to engage the metric hex at the extension top and will reach the hex on a 7" U.S.A.-type extension.



### TL-633 Valve Cap Tool

The TL-633 makes it easy to remove and install valve caps on inside dual wheels. Designed for aluminum wheels with small hand holes, it comes with a protective sleeve to prevent scratching. Also works great at removing tight or cross-threaded caps. Positive hold while valve is serviced. Keeps cap in tool.



### TL-635 Standard Bore Valve Core Tool

Haltec equivalent to Schrader 2688 and Eaton 5406. Tool is made from hex steel, making it very sturdy, yet economical.



### TL-645 Valve Fishing Tool

Combines valve core wrench and deflating pin with flexible cable for fishing valve thru rim hole. Available in 24" - TL-645-24

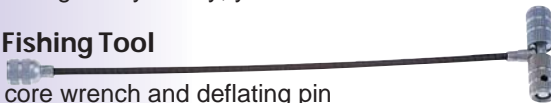

### TL-650 Fishing Tool

Guides, aligns and holds valve through valve hole while mounting tire.

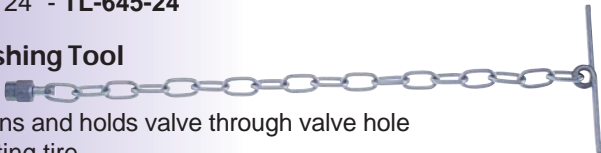

### TL-665 Valve Stem Installation Tool

Rugged tool handles any length valve in any size rim. Screws over valve threads and quickly installs valve into valve hole by applying pulling pressure.



### TL-610 Standard Bore 4-Way Valve Tool

Repairs and reconditions inside and outside valve threads. Inserts and removes cores. Corrosion-resistant, cadmium-plated.



### TL-615 Standard Bore 2-in-1 Valve Tool

Combination valve core remover and deflator. Corrosion-resistant, cadmium-plated.



### ASP-1 Tube Standard Bore Deflating Aspirator

Creates vacuum by screwing aspirator onto valve mouth and applying air chuck to threaded inlet. Fits Standard Bore valves.



Fits Large Bore

Fits Standard Bore

### TL-685 Core Installation Tool



**8909-C**  
Guides, aligns, and holds Large bore valve through rim hole while mounting the tire.



# Standard Bore Tools

TOLL FREE: 800-321-6471

www.haltec.com



# Automatic Tire Inflation Systems



## 89MDA - Automatic Digital Tire Inflator

- Inflates or deflates automatically
- Accurate to within .3 psi
- 1/4" inlet & outlet
- Maintenance free
- **Indoor use only**
- Self calibrates every 6 minutes
- Can be customized to any corporate image & language text



## 89XDA - Heavy Duty Digital Tire Inflator

- The heavy duty, weatherproof and vandal resistant enclosure of the 89XDA makes it ideal for almost any indoor or outdoor location.
- Inflates or deflates automatically
- Accurate to within .3 psi
- 1/4" inlet & outlet
- Maintenance free
- Self calibrates every 6 minutes
- Can be customized to any corporate image & language text



## 89XDB - Heavy Duty High Volume Tire Inflator System

- Designed specifically for inflating large OTR tires or multiple truck tires
- Indoor or outdoor use
- Inflates 1 to 4 tires simultaneously
- 1/2" inlet maximizes air flow
- Accurate to within .3 psi



## Ideal for Retread Centers, Tire Service Centers and Tire Mounters

### 89XDZ - Over Inflation Tire System

- Utilizes 1/2" inlet maximizing air flow
- Equipped with emergency stop control
- Accurate to within .3 psi
- Dual LCD screens
- Preset feature stores the 3 most common pressure settings
- Leak detection test
- Multiple purge cycle setting
- Indoor or outdoor use

### SAFE, ACCURATE & EASY OPERATION

- Increases tire life
- Increases vehicle performance
- Increases gas mileage
- Each model is designed to allow service technician to back-away during tire inflation.

## TECHNICAL SPECIFICATIONS

CONSTRUCTION	Die Cast Aluminum Enclosure Polycarbonate Enclosure
POWER REQUIREMENT	110V a.c. or 12V d.c.
UNIT OF MEASUREMENT	1 psi, kpa & bar available
OPERATING RANGE	5-145 psi (other ranges available)
OPERATING TEMPERATURE	14 ° F to 122° F (-4° F to 122° F with optional heater)

TOLL FREE: 800-321-6471

[www.haltec.com](http://www.haltec.com)





89HKC-12



89HKC-25C



## Automatic Tire Inflation System Accessories for 89MDA (Grey) & 89XDA (Blue) (Single)

Haltec No.	Product Description
89HKC-12	12' Straight hose w/coupler & CH-360OP air chuck
89HKC-24	24' Straight hose w/coupler & CH-360OP air chuck
89HKC-50	50' Straight hose w/coupler & CH-360OP air chuck
89HKC-25C	25' Blue coil hose w/coupler & CH-360OP air chuck
89HKC-50C	50' Blue coil hose w/coupler & CH-360OP air chuck
89HKT-12	12' Straight hose w/coupler & CH-330 LO-OP air chuck
89HKT-24	24' Straight hose w/coupler & CH-330-LO-OP air chuck
89HKT-50	50' Straight hose w/coupler & CH-330-LO-OP air chuck
89HKI-25	25' Straight hose w/coupler & IN-20 air chuck
89-2 WASV	2-way automatic switching valve (2 hoses)
89-3 WASV	3-way automatic switching valve (3 hoses)
89-3 WTK	3-way automatic switching valve kit (tubing system)
CH-360OP-1	Clip-on style air chuck (open)
CH-330-LO-OP-1	Lock-on style air chuck (Dual Wheels)
IN-20	Core removing & inflation tool (Car)
STAND-4	4' Yellow mounting steel stand w/square base

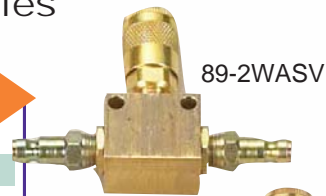

89-2WASV

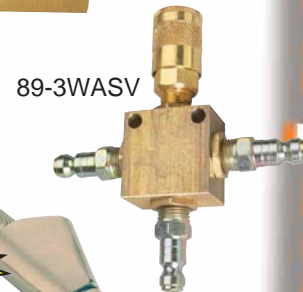

89-3WASV



IN-20

## Automatic Tire Inflation System Accessories for 89XDB (Yellow) & 89XDZ (Red) (Multiple)

Haltec No.	Product Description
89HKC-12M	12' Straight hose w/CH-360 air chuck
89HKC-24M	24' Straight hose w/CH-360 air chuck
89HKT-12M	12' Straight hose w/CH-330 LO air chuck
89HKT-24M	24' Straight hose w/CH-330 air chuck
89HVI-25	25' Straight hose w/coupler & IN-20 air chuck (Single Tire Applicator)
89-HMVN	4-way manifold
89-3W	Air flow control valve
CH-360-1	Clip-on style air chuck (closed)
CH-330-LO-1	Lock-on style air chuck (Dual Wheels)
STAND-4	4' Yellow mounting steel stand w/square base



89-3W

STAND-4

TOLL FREE: 800-321-6471

www.haltec.com

Inflation Systems Accessories



#### NOTE

Purging is defined as removing the air from the tire and re-inflating with nitrogen

# Nitrogen Inflation Systems

Ideal for:

- Fleet Operations
- Tire Service Centers
- Auto Dealerships

## 89TRL

89TRL offers a mobil solution for nitrogen tire inflation. The all-new nitrogen software will purge the air out of any size tire, re-inflate with nitrogen, maintaining its accuracy of .3psi. Designate the number of purge cycles to guarantee the purity level needed to obtain the benefits of nitrogen inflation over standard air inflation. Operation is identical to 89XDB-G Inflation System.

Ideal for:

- Auto Dealerships
- Truck Service Centers
- Any Service Center currently inflating with Nitrogen

## 89XDB-G



89XDB-G compliments any Nitrogen Generator. The Mountable Inflation System allows any technician to set the pressure, attach the nitrogen hoses, and press start. The all-new nitrogen software will purge the air out of any size tire, re-inflate with nitrogen, maintaining its accuracy of .3psi. Designate the number of purge cycles to guarantee the purity level needed to obtain the benefits of nitrogen inflation over standard air inflation. The 89XDB-G will convert up to 4 tires at once. The aluminum enclosure enables the system to be mounted in any climate. Optional heater (P/N 89HEAT) for colder climates is available.



\* Nitrogen bottle and regulator not included.

TOLL FREE: 800-321-6471

[www.haltec.com](http://www.haltec.com)





89HVI-25



NITRO-1

## Nitrogen Inflation Accessories for the 89XDB-G (Green)

Haltec No.	Product Description
89-3W	Air flow control valve
89-HMVN	4-way manifold
89HVI-25	25' Green hose w/coupler & IN-20 tire chuck (Single Tire Application)
89HVC-12G	12' Green hose w/coupler & CH-360OP-1 clip-on tire chuck (Single tire application)
89HVC-24G	24' Green hose w/coupler & CH-360OP-1 clip-on tire chuck (Single tire application)
89HVC-50G	50' Green hose w/coupler & CH-360OP-1 clip-on tire chuck (Single tire application)
89HKC-12MG	12' Green hose w/CH-360-1 clip-on tire chuck (Multiple tire application)
89HKC-24MG	24' Green hose w/CH-360-1 clip-on tire chuck (Multiple tire application)
IN-20	Core removal & inflation tire chuck
STAND-4	4' Yellow mounting stand w/square base
A-100-VC-8G	Green valve caps
568-011G	Green O-rings for tire valve
NITRO-1	Nitrogen Purity Gauge



A-100-VC-8G



568-011G

TRL-H-CH-360OP



## Nitrogen Inflation Accessories for the 89TRL

Haltec No.	Product Description
TRL-BAT	Plug & rechargeable Battery
TRL-H-25	25' black hose
TRL-H-IN-20	6" black hose w/IN-20
TRL-H-CH-360OP	6" black hose w/CH-360OP-1
TRL-H-N1200	6" black hose w/small clip on air chuck
TRL-COUP	Silver coupler
IN-20	Core removal & inflation tire chuck
A-100-VC-8G	Green valve caps
568-011G	Green o-rings for tire valve
NITRO-1	Nitrogen Purity Gauge

TRL-H-N1200

TOLL FREE: 800-321-6471

www.haltec.com

Nitrogen Inflation Systems Acc.





### I-405 Inflating Gauge Meets OSHA Requirements

Inflation unit with in-line gauge. Lightweight aluminum body with brass movement and O-rings seals. Calibrated 10-120 psi in 2 lb. increments - precise inflation control - 1/4" female NPT inlet with CH-360-OP clip-on air chuck. Also available with hose lengths of 3' or 9'. Specify length when ordering.

### I-405-LO Inflating Gauge

Same as I-405 above except with CH-330-LO lock-on chuck for use on aluminum wheels.

### Air Master Dial Gauge



Haltec Air Master Dial Gauge comes in a variety of hose lengths and chuck types to meet the varied needs of the tire professional. The inflator is compact with an ergonomic design that makes the gauge comfortable to operate and easy to use. One button allows the operator to inflate or deflate. the gauge reads from 4 to 140 psi in 2 pound increments and is also calibrated from 0 to 10 bars in .1 bar increments. The dial gauge is protected with a ribbed rubber shroud.



Haltec No.	Description	Hose Length	Air Chuck
I-405-3M	Inflator with Clip-on Air Chuck	3'	CH-360-OP
I-405-6M	Inflator with Clip-on Air Chuck	6'	CH-360-OP
I-405-9M	Inflator with Clip-on Air Chuck	9'	CH-360-OP
I-405-12M	Inflator with Clip-on Air Chuck	12'	CH-360-OP
I-405-3LOM	Inflator with Lock-on Air Chuck	3'	CH-330-OP
I-405-6LOM	Inflator with Lock-on Air Chuck	6'	CH-330-OP
I-405-9LOM	Inflator with Lock-on Air Chuck	9'	CH-330-OP
I-405-12LOM	Inflator with Lock-on Air Chuck	12'	CH-330-OP

Haltec No.	Description	Hose Length	Air Chuck
I-420	Dial Gauge Inflator	16"	N-1200
I-415-3	Dial Gauge Inflator	3'	CH-360-OP
I-415-6	Dial Gauge Inflator	6'	CH-360-OP
I-415-9	Dial Gauge Inflator	9'	CH-360-OP
I-415-12	Dial Gauge Inflator	12'	CH-360-OP
I-430-3	Dial Gauge Inflator	3'	CH-330-OP
I-430-6	Dial Gauge Inflator	6'	CH-330-OP
I-430-9	Dial Gauge Inflator	9'	CH-330-OP
I-430-12	Dial Gauge Inflator	12'	CH-330-OP

### I-406M Inflating Gauge

Has 12" of hose and CH-335 dual foot air chuck to service small diameter wheels. Gauge is calibrated 10-120 psi in 2 lb. increments.

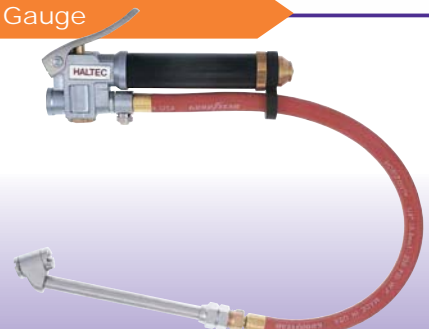

### I-400 Large Bore Inflator

Same as I-401 below except with 10013 Large Bore screw-on chuck.



### I-401 Extra Heavy Duty Large Bore Inflator With Straight Clip-On Chuck

Five-foot Large Bore inflator has 1/2" ball valve with provision for checking air pressure and

H-4660A straight lock-on chuck. Rubber hose is 5' long. Inflator has a 3/8" I.D. for maximum air flow. Threaded for 1/2" male NPT hose fittings.



### I-402 Series Safety Inflator

Available in 3' and 6' lengths. Has pressure check valve for exact pressure check with your pencil gauge. Has manual bleed valve for adjusting tire pressure and CH-360-OP flow through clip-on chuck.



### SAFETY PRECAUTION

These products, as well as all tire tools, should never be used by persons unless they have been trained properly according to O.S.H.A. Regulation #29CFR 1910.177 entitled "Servicing Single-Piece & Multi-Piece Rim Wheels."

### I-404 Heavy-Duty Hose Inflator

Heavy-duty inflator has two separate clip-on chucks with five-foot hoses. One chuck, CH-360, fits Standard Bore valves and the other, H-4660A, Large Bore valves. Has spring-loaded, hand-operated valve and has provisions for checking air pressure during inflation. Threaded for 1/4" male NPT hose fittings.



### I-408 Dual Tire Inflator Gauge

Has five-foot hose to a tee connection, 2' of hose on each side with 12" sliding sleeve, lock-on chuck for easy access to inner dual and dual foot lock-on chuck for outer dual tire. Allows user to engage and disengage chuck quickly. As the same air source serves the unit, both tires are automatically inflated equally. Lock-on chuck fits any standard truck valve stem or the DS-1 double seal cap.

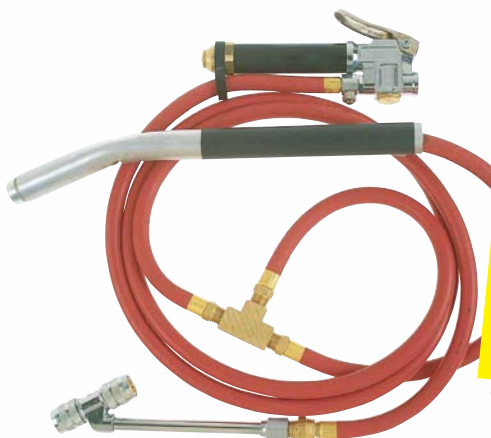

### I-409 Large Bore Inflation Gauge

Large Bore inflation unit with in-line gauge. Equipped with H-4660A chuck and a 6' hose. Gauge is calibrated 10-120 psi in 2 lb. increments.



### 10013 Large Bore Screw-On Chuck

Fits 3/8" I.D. air hose.





Haltec couplers and nipples are long-lasting, high performance products. They are rated for pressure up to 300 psi with an operating temperature range of -40° F to +250° F. The 1/4" couplers have a 4-ball locking device while

the 3/8" and 1/2" series offer an 8-ball locking device. The nipples have hardened wear points and are made from solid barstock construction to provide long service life. Made in U.S.A.



CO-101



CO-103



CO-105



NI-102



NI-104



NI-106

## 1/4" TRU-FLATE TYPE

Haltec NO.	Descrip.	NPT	Thread Type	Schrader	Dill	Amflo	Camel	Milton	Tru-Flate
CO-101	Coupler	1/4"	Male	3503	D-12	C1	61-524	786	13-124
CO-103	Coupler	1/4"	Female	3504	D-13	C2	61-523	785	13-134
CO-105	Coupler	1/4"	Female	3505	-	C2R	61-487	-	-
NI-102	Nipple	1/4"	Male	3506	D-2C	CP1	61-538	783	12-124
NI-104	Nipple	1/4"	Female	3507	D-3C	CP2	61-539	784	12-134
NI-106	Nipple	fits 302"-32	Female	3508	D-6C	CP12	-	779	12-104



CO-501



NI-502



NI-504

## 1/4" ARO TYPE

Haltec NO.	Descrip.	NPT	Thread Type	Schrader	Dill	Amflo	Camel	Milton	Tru-Flate
CO-501	Coupler	1/4"	Female	3526	8888	C38	61-526	775	13-324
NI-502	Nipple	1/4"	Male	3529	8891	CP37	61-528	777	12-325
NI-504	Nipple	1/4"	Female	3530	8889	CP38	61-529	778	12-335



CO-701



NI-702



NI-704

## 1/4" LINCOLN TYPE

Haltec NO.	Descrip.	NPT	Thread Type	Schrader	Dill	Amflo	Camel	Milton	Tru-Flate
CO-701	Coupler	1/4"	Female	3528	123	C28	61-548	790	13-434
NI-702	Nipple	1/4"	Male	3531	126	CP27	61-550	791	12-424
NI-704	Nipple	1/4"	Female	3532	125	CP28	61-551	792	12-434



CO-201



CO-301



CO-303



NI-202



NI-204

## 1/4" INDUSTRIAL TYPE

Haltec NO.	Descrip.	NPT	Thread Type	Schrader	Dill	Amflo	Camel	Milton	Tru-Flate
NI-202	Nipple	1/4"	Male	5138-11	110	CP21	61-578	727	12-225
CO-301	Coupler*	1/4"	Female	5138-12	-	-	-	-	-
NI-204	Nipple	1/4"	Female	5139-11	109	CP20	61-579	728	12-235
CO-303	Coupler*	1/4"	Male	5139-12	-	-	-	-	-
CO-201	Coupler	1/4"	Female	5142-12	102	C20	61-573	715	13-235

\*Push-Type





CO-204



NI-206



NI-208

## 3/8" INDUSTRIAL TYPE

Haltec NO.	Descrip.	NPT	Thread Type	Schrader	Dill	Amflo	Camel	Milton	Tru-Flate
CO-204	Coupler	3/8"	Female	3541	117	C26	61-482	1835	13-537
NI-206	Nipple	3/8"	Male	3542	121	CP25	61-484	1837	12-527
NI-208	Nipple	3/8"	Female	3543	122	CP26	61-485	1838	-



CO-107



CO-109



NI-108



NI-110

## 3/8" TRU-FLATE TYPE

Haltec NO.	Descrip.	NPT	Thread Type	Schrader	Dill	Amflo	Camel	Milton	Tru-Flate
CO-107	Coupler	3/8"	Male	3515	-	C5	61-554	1806	13-107
CO-109	Coupler	3/8"	Female	3516	D-15	C6	61-553	1805	13-613
NI-108	Nipple	3/8"	Male	3517	D-2E	CP5	61-558	1807	12-605
NI-110	Nipple	3/8"	Female	3518	D-3E	CP6	61-559	1808	12-612



CO-111



NI-112



NI-113

## 1/2" TRU-FLATE TYPE

Haltec NO.	Descrip.	NPT	Thread Type	Schrader	Dill	Amflo	Camel	Milton	Tru-Flate
CO-111	Coupler	1/2"	Female	3512	D-17	C10	61-563	1815	13-713
CO-111R	Coupler	1/2"	Female	D-17R	C10R	-	-	-	13-712/713
NI-112	Nipple	1/2"	Male	3513	D-2F	CP9	61-568	1817	12-705
NI-113	Nipple	1/2"	Female	-	-	CP18	-	1858	12-762
CO-112	Coupler	1/2"	Male	-	-	-	-	-	-



CO-800

## UNIVERSAL COUPLERS



CO-801

Haltec NO.	Descrip.	NPT	Thread Type	Schrader	Dill	Amflo	Camel	Milton	Tru-Flate
CO-800	Coupler	1/4" - 18 NPTF	Female	-	-	C60	61-240	-	-
CO-801	Coupler	1/4" - 18 NPTF	Male	-	-	C61	61-241	-	-

### Features:

- The 1/4" universal coupler will accept the industrial interchange [(MIL-C4109) and (ANSI/(NFPA) T3.20.14-1990)] Tru-Flate and the ARO style nipples.
- The coupler features automatic push-to-connect operation, high flow machined "window valve," corrosion-resistant, solid-brass construction and a sleeve guard which helps prevent accidental disconnects and protects the sleeve from damage.
- While the best quick-coupling performance is obtained by matching like series couplers and nipples, the universal coupler permits multiple series nipples to mate with one coupler.



# ACCESSORIES PRODUCTS BULLETIN

## Introducing Three Great NEW Products!

### ALUMINUM CARE SYSTEM

**NEW  
Product!**

**PART NO.**  
ALC-CC-16



#### PDQ Chrome Cleaner

- Cleans, polishes and brightens chrome surfaces.
- Removes rust, corrosion and oxidation.
- For use on chrome plated wheels and bumpers.
- Wipe on/Wipe off application.
- Not for use on clear coated or polished aluminum surfaces.
- Removes brake dust in one step.
- Chemically loosens rust and corrosion from surface for easy cleaning.

1. PART NO. ALC-13S - Sealant
2. PART NO. ALC-22C - Cleaner
3. PART NO. ALC-16P - Heavy Duty Polish
4. PART NO. ALC-PDQ16 - PDQ Polish

ALC-KIT - Includes: Sealant, Heavy  
Duty Polish, & Cleaner



### VALVE STEM EXTENSION STABILIZER



PART NO. H-8864  
Oblong, fits 88364x+98364x,  
2.50" off-center hole.

**NEW  
Product!**



PART NO. H-8964  
Oblong, fits prevost 89364,  
2.00" off-center hole.

**NEW  
Product!**

**Alcoa Accessories**

TOLL FREE: 800-321-6471

[www.haltec.com](http://www.haltec.com)



## AXLE END COVERS

*(All closed-end axle covers are supplied with an Alcoa Medallion)*

- For use on 16 x 7 aluminum wheels
- Includes rubber O-rings

- All-aluminum
- Made in the U.S.A.

\* Mounts from the front



H-1611\*



Height: 1.125" straight.  
For Dodge/Ford  
dualie applications  
Bolt pattern: 8 x 6.50

H-1612\*



Height: 4.750" straight.  
For Dodge/Ford  
dualie applications  
Bolt pattern: 8 x 6.50

H-1681\*



Height: 4.750" straight.  
w/3.50" open end  
For Dodge/Ford  
dualie applications  
Bolt pattern: 8 x 6.50

H-2167



Height: 5.875" straight.  
Hub bores: 5.150"  
Bolt pattern: 8 x 6.50

H-3167



Height: 4.700" straight.  
Hub bores: 5.150"  
Bolt pattern: 8 x 6.50

H-3267



Height: 2.000" straight.  
Hub bores: 5.150"  
Bolt pattern: 8 x 6.50

H-3611\*



Height: 1.125" straight.  
For Chevy dualie apps.  
Bolt pattern: 8 x 6.50

H-3612\*



Height: 4.750" straight.  
For Chevy dualie apps.  
Bolt pattern: 8 x 6.50

H-4167



Height: 4.000" straight.  
Hub bores: 5.150"  
Bolt pattern: 8 x 6.50

H-5167



Height: 4.150" straight.  
Hub bores: 4.250"  
Bolt patterns: 5 x 5.50  
& 8 x 6.50

H-5267



Height: 2.000" straight.  
Hub bores: 4.250"  
Bolt patterns: 5 x 5.50  
& 8 x 6.50

H-6167



Height: 4.000" straight  
with 3.750" open end  
Hub bores: 4.250". Bolt  
patterns: 5 x 5.50 & 6 x 5.50

H-7167



Height: 4.000" bullet  
shape. Hub bores:  
4.250". Bolt patterns:  
5 x 5.50 & 6 x 5.50

H-8167



Height: 4.650" straight  
with 4.500" open end  
Hub bores: 5.150"  
Bolt pattern: 8 x 6.50

H-9167



Height: 3.094"  
straight Hub bore:  
3.295". Bolt patterns:  
5 x 4.50, 5 x 4.75,  
5 x 5.00 & 6 x 4.50

H-9267



Height: 2.00" straight  
Hub bore: 3.295"  
Bolt patterns: 5 x 4.50,  
5 x 4.75, 5 x 5.50 &  
6 x 5.50

H-11167



Height: 3.688" straight.  
with 2.193" open end  
Hub bore: 3.295". Bolt  
patterns: 5 x 4.50, 5 x  
4.75, 5 x 5.00 & 6 x 4.50

H-11911\*



Height: 1.500" straight  
Hub bores: 5.250" &  
5.460"  
Bolt pattern: 10 x 7.25

H-11912\*



Height: 5.375" straight  
Hub bores: 5.250" &  
5.460"  
Bolt pattern: 10 x 7.25

H-12167



Height: 2.863" bullet  
shape  
Hub bore: 4.250"  
Bolt patterns: 5 x 5.50  
& 6 x 5.50

16" Alcoa Wheel Accessories

TOLL FREE: 800-321-6471

www.halttec.com





# Alcoa Forged Aluminum Wheel Mounting Hardware



## Alcoa Mounting Hardware 60° Cone Seat Cap Nut

Each lug nut has specific inner threads for each application with universal outside threads to accept the Alcoa chrome-plated nut cover (See H-78 & H-79)



## 16" x 7" 1 PC. LUG NUT FOR ALCOA SINGLE STUD PILOT WHEELS

Haltec No.	Thread Size	Hex	Torque
5012	M12 x 1.5	7/8"	80-90 ft. lbs.
5014	M14 x 1.5	7/8"	100-110 ft. lbs.
5120	1/2 x 20	7/8"	90-100 ft. lbs.
5716	7/16 x 20	7/8"	90-100 ft. lbs.
5916	9/16 x 18	7/8"	120-140 ft. lbs.

## 5996R/5996L 1-1/8" x 16 Cap Nut

Mounts standard single wheels and wide base wheels to 1-1/8" studs and provides additional 1/8" hex height. Also mounts outer dual wheel to 1-1/8" inner cap nut.



## 5988R/5988L Inner Cap Nut

For use with standard length studs (1.31" to 1.44" stud standout) or longer studs not to exceed 1.88" stud standout. Full external threads, counter bore 5/16" deep at open end. For use with aluminum inner and outer wheels. Prevents stud from bottoming out in cap nut.



## 5995R/5995L 3/4" x 16 Cap Nut

Mounts standard single wheels and wide base wheels to 3/4" studs.



## 7896R/7896L Inner Cap Nut

Inner thread 3/4" x 16, outer thread 1-1/8" x 16. For use with steel inner dual wheel and aluminum outer dual wheel with 1.31" to 1.44" stud standout.

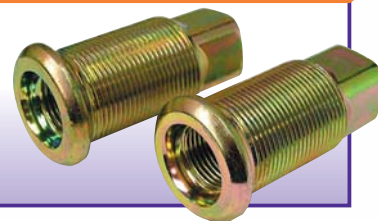

## 2-PIECE FLANGE LUG NUTS FOR ALCOA SINGLE & DUAL HUB-PILOT WHEELS



Haltec No.	Description	Torque
2 piece flange lug nuts (for hub pilot 16 x 6 wheels and some 19.5" RV wheels)		
139698	M14 x 1.5, 1.050" hex	80-90 ft. lbs.
139987	9/16" x 18, 1.050" hex	130-150 ft. lbs.
039946	5/8" x 18, 1 1/16" hex	90-100 ft. lbs.

## 39874 Flange Nut

Two-piece, 33mm hex, M22 x 1.5mm, RH thread flange nut. Mounts single and dual wheels to wheel centering hubs. Right hand threads used both sides of vehicle. Single wheels require 2" (50.8mm) stud standout. Dual wheels require 2-13/16" stud standout.



## 430632 Cap Nut

Two-piece, 33mm hex, M22 x 1.5mm, RH thread thread, sleeved cap nut. Mounts single aluminum wheels, with 32mm bolt holes, to wheel centering hubs with stud standouts less than 1.92" (48.75mm). Right-hand threads used on both sides of vehicle.



## 430732 Cap Nut

Two-piece, 33mm hex, M22 x 1.5mm, RH thread thread, sleeved cap nut. Mounts dual aluminum wheels, with 32mm bolt holes, to wheel centering hubs with stud standouts less than 2.85" (72mm). Right-hand threads used on both sides of vehicle.



TOLL FREE: 800-321-6471

www.haltec.com

H-1503



10 H-150 Hug-A-Lugs  
in a plastic clamshell.  
Versatile 10-pack design.

H-1813



10 H-181 Hug-A-Lugs  
in a plastic clamshell.  
Versatile 10-pack design.

Patented spring-clip insert holds cover tight to the nut, yet permits easy installation and removal. Available for ball seal cap nuts for stud located wheels and the new Alcoa Hug-A-Lug® nut cover for the two-piece flange nut for hub-piloted wheels.

Now Alcoa Hug-A-Lug nut covers come in handy plastic "clamshell" packs for easy retail display. The versatile design of the 10-pack nut covers allows it to stand alone or hang on a display rack.

NOTE: Orders are accepted for less than case quantities.



## FOR 1 1/2" HEX STUD-PILOT WHEELS

Haltec No.	Description	Case Qty.	Finish
H-150	For 1 1/2" Hex Stud-pilot Nut	200	Chrome



## FOR 33MM HEX FLANGE NUTS (HUB-PILOT WHEELS)

Haltec No.	Description	For Heights	Case Qty.	Finish
H-180	For 33mm Hex Flange Nut for buses	.886"-1.0"	200	Chrome
H-181	For 33mm Hex Flange Nut for buses	27-31mm	200	Chrome



## FOR 1 1/2 HEX NUTS (HUB-PILOT WHEELS)

Haltec No.	Description	For Heights	Case Qty.	Finish
H-182	For 1 1/2 Hex Flange Nut for trucks	1 7/16"	200	Chrome
H-183	For 1 1/2 Hex Flange Nut for buses	7/8"	200	Chrome



## FOR ALOCA LUG NUTS FOR 16" & 19" WHEELS

Haltec No.	Description	For Heights	Case Qty.	Finish
H-78	2.125"	.96"	100	Chrome
H-79	1.525" Tall	.96"	100	Chrome
H-190	Hug-A-Lug	Fits 1 1/16" nuts	200	Chrome



TOLL FREE: 800-321-6471

www.haltec.com

# Alcoa Wheel Cover Kits







076085

## FRONT STEER WHEEL HUB COVER KITS FOR 10-HOLE 22.5" & 24.5" WHEELS



076185

### H-155

1 1/2" nut cover with an inner clamp and threaded outer cover. To order inner clamp only, ask for Part # H-155C.



### 500

Installation tool for hub cover systems 076155 and 077155.

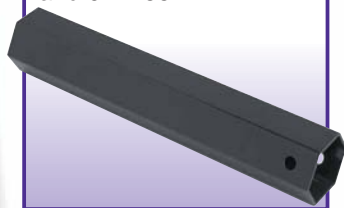

Haltec No.	Wheel Type	Nut Cover	Application /Package
076185*	Hub Piloted	H-185 (33mm)	Cover is secured by screwing the H-185 directly onto stud threads; Clamshell
076155	Ball-Seat	H-155 (1 1/2")	Cover is secured by screwing the H-155 onto inner clamp. Inner clamp is placed on stud threads; Clamshell
076188	Hub Piloted	H-188 (33mm)	Cover is secured by screwing the H-188 onto inner clamp, Inner clamp is placed on stud threads; Clamshell
076085*	Hub Piloted	H-185 (33mm)	Cover is secured by screwing the H-185 directly onto stud threads; Reusable Bin includes 20 nut covers, 2 hub covers & tool
076015	Ball-Seat	H-155 (1 1/2")	Cover is secured by screwing the H-155 onto inner clamp. Inner clamp is placed on stud threads; Reusable Bin includes 20 nut covers, 20 inner clamps, 2 hub covers & tool
076018	Hub Piloted	H-188 (33mm)	Cover is secured by screwing the H-188 onto inner clamp. Inner clamp is placed on stud threads; Reusable Bin includes 20 nut covers, 20 inner clamps, 2 hub covers & tool

\* Requires a minimum of 4 threads per stud

• To order Hub Cover Systems in standard cardboard box packaging add a "B" to the end of the part number. **Example 076185B**





# Alcoa Rear Hub Cover Kits



## REAR DRIVE WHEEL COVER KITS FOR 10 HOLE 22.5" & 24.5" WHEELS

Haltec No.	Wheel Type	Nut Cover	Application
077185*	Hub Pilot	H-185 (33mm)	Cover is secured by screwing the H-185 directly onto stud threads; Clamshell
077155	Stud Pilot	H-155 (1 1/2")	Cover is secured by screwing the H-155 onto inner clamp. Inner clamp is placed on stud threads; Clamshell
077188	Hub Pilot	H-188 (33mm)	Cover is secured by screwing the H-188 onto inner clamp. Inner clamp is placed on stud threads; Clamshell
077085*	Hub Pilot	H-185 (33mm)	Cover is secured by screwing the H-185 directly onto stud threads; Reusable Bin includes 40 nut covers, 4 hub covers & tool
077015	Stud Pilot	H-155 (1 1/2")	Cover is secured by screwing the H-155 onto inner clamp. Inner clamp is placed on stud threads; Reusable Bin includes 40 nut covers, 40 inner clamps, 4 hub covers & tool
077018	Hub Pilot	H-188 (33mm)	Cover is secured by screwing the H-188 onto inner clamp. Inner clamp is placed on stud threads; Reusable Bin includes 40 nut covers, 40 inner clamps, 4 hub covers & tool

\* Requires a minimum of 4 threads per stud.

- To order Hub Cover Systems in standard cardboard box packaging add a "B" to the end of the part number. **Example 077185B**

### H-185



33mm screw-on nut cover for hub covers 076185 and 077185.

### H-188



33mm nut cover with an inner clamp threaded out cover. To order inner clamp only, ask for Part# H-188c.

### 600

Installation tool for hub cover systems 076185, 077185, 076188 and 077188.

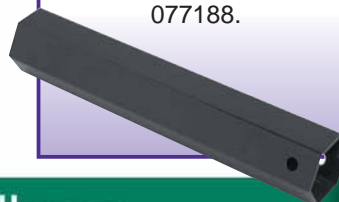

TOLL FREE: 800-321-6471

www.haltec.com



# Alcoa Hub Cover Kits

001102



**NEW**

001103



**NEW**

H-20



For 30mm hex flange nuts.  
\*Requires minimum 3 threads protruding through lug nut; Black spacer not applicable w/short lug nut.

## LIGHT DUTY TRUCKS

Haltec No.	Wheel Size	Bolt Circle	Package Includes
001102	19.5" x 6" Hub Pilot	8 x 225mm	2 Fronts
001103	19.5" x 6" Hub Pilot	8 x 225mm	2 Rears
110203	19.5" x 6" Hub Pilot	8 x 225mm	2 Front - 2 Rears

**Application:** Snaps on over lugnuts and center hub.

008221



**NEW**

008222



**NEW**

H-22



For 33mm hex flange nuts.  
\*Requires minimum 3 threads protruding through lug nut; Black spacer not applicable w/short lug nut.

## TRUCKS, BUSES AND TRAILERS

Haltec No.	Description	Bolt Circle	Kit Includes
082012	For 30mm hex flange nuts	8 x 275mm	2-008221, 2-008222, 32-H-20
082122	For 33mm hex flange nuts; steers	8 x 275mm	2-008221, 16 H-22
082133	For 33mm hex flange nuts; drivers	8 x 275mm	2-008222, 16 H-22
008201	Front Hub Cover Kit for 30mm hex flange nuts	8 x 275mm	1 Front Hub Cover & 8 lug nut covers (H-20)
008202	Rear Hub Cover Kit for 30mm hex flange nuts	8 x 275mm	1 Rear Hub Cover & 8 lug nut covers (H-20)
008221	Front Hub Cover Kit for 33mm hex flange nuts	8 x 275mm	1 Front Hub Cover & 8 lug nut covers (H-22)
008222	Rear Hub Cover Kit for 33mm hex flange nuts	8 x 275mm	1 Rear Hub Cover & 8 lug nut covers (H-22)

**Application:** Place cover over hub and secure with nut cover.

TOLL FREE: 800-321-6471

www.haltec.com



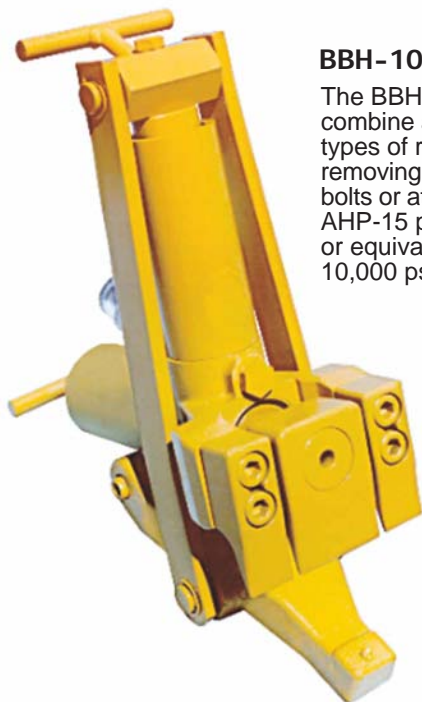

### BBH-10 "COMBI" BEAD BREAKER

The BBH-10 is ideal for use with all truck, farm tractor, grader, combine and skidder tires. The air hydraulic movement works on all types of rims except 5-piece earthmover rims. Can be used without removing the wheel and will not damage the bead or rim. No screws, bolts or attachments. Can be used with Haltec model AHP-20 pump, AHP-15 pump or equivalent 10,000 psi pump.



### Talon-1 OTR Bead Breaker

- Works on both front and back wheel without dismounting wheel from vehicle
- Works on all new 3 piece 25" wheels or larger
- Works on all wheels with CAT "Shur-Lok" safety feature
- A must tool for all trucks



### OTR-1825 Bead Breaker

Off-the road bead breaker tool. Used on 25" to 51" 5-piece rims with pry bar pockets. Has 4 1/4" stroke and is designed to break earthmover tire beads on rusted rims. Can be used with Haltec model AHP-15 pump or equivalent 10,000 psi pump, 17" length. Caterpillar conversion kit available. Order part OTR-1825CK.



### OTR-2000 Giant Tire/Wheel Bead Breaking Tool

Designed for largest construction and off-road tires and wheels. Works on all 39", 45", 51" and 57" wheel sizes.

Can be used with Haltec model AHP-20 pump, AHP-15 pump or equivalent 10,000 psi pump.

**Note:** Due to design changes, the OTR-2000 frame and ram will not interchange with Goodyear TO-2000 tools. All other parts are interchangeable.



### AHP-15 Hydraulic Pump

- Fast-acting air hydraulic pump that can be used with all Haltec Bead Breakers
- 10,000 psi rated
- Capacity 3.5 qts. oil
- Hose not included
- Polyglass reservoir

### AHP-20H

- 8 foot hose with coupler for use on all hydraulic pumps.



### AHP-20 Hydraulic Pump

- Fast-acting air hydraulic pump that can be used with all Haltec Bead Breakers
- 10,000 psi rated
- Capacity 5 qts. oil
- Hose not included
- Polyglass reservoir

TOLL FREE: 800-321-6471

www.haltec.com

57  
Bead Breakers/Bead Breaker Pumps





# Hydraulic Rams & Jacks



These rams are recommended for use in pushing off-rear beads on earthmover wheels. Can be used for all earthmover tire trucks. Can also be used as a general purpose cylinder. Maximum operating pressure of 10,000 psi. Designed for use in all positions. Made in USA. A coupler and dust cap are included with all models.



**SAFETY PRECAUTION**

These products, as well as all tire tools, should never be used by persons unless they have been trained properly according to O.S.H.A. Regulation #29CFR 1910.177 entitled "Servicing Single-Piece & Multi-Piece Rim Wheels."

Haltec No.	Cylinder Capacity (tons)	Stroke (inches)	Cylinder Effective Area (in <sup>2</sup> )	Oil Capacity (in <sup>3</sup> )	Collapsed Height (in)	Weight (lbs.)
AJ-102	10	2.13	2.23	4.75	4.78	5.1
AJ-106	10	6.13	2.23	13.67	9.75	9.4
AJ-110	10	10.13	2.23	22.59	13.75	12.9
AJ-30	30	2.44	6.50	15.85	4.50	13.8
AJ-506	50	6.00	11.05	66.30	10.97	31.5
AJ-1006	100	6.00	20.65	136.91	14.06	45.0



## AJ-30

The AJ-30 "shorty" is a light-weight, low-profile design for use in confined places. Cylinder capacity is 30 tons.



## AJ-506-B

The AJ-506B 50-ton aluminum jack is easy-to-handle and light-weight, it can be used with any 10,000 psi pump. Perfect for off-highway work. Comes with a 7" x 7" aluminum base.

## AJ-506AB

7" x 7" aluminum base for use with the AJ-506.

## Bead Holding Device

Holds the bead in place against the wheel when mounting the tire on to the wheel. Not a prying device.



## Impact Bead Breakers

Bead breaker loosens beads with bead-breaking foot and ram bar, but never cuts the bead of the tire. The wedge foot is forced between the bead and rim flange. Breaker is designed for shop or road use. No other bead breaker tools are necessary.

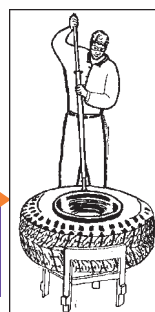

T26B has exclusive spring-action design to reduce user fatigue associated with slide hammer kickback.

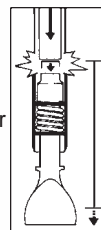

Part #	EDP #	Description	Length	Length Extended	Weight
T26B	35926	Heavy-duty	50" (127.0cm)	80" (203.2cm)	24 lbs. (10.9kg)

## Handled Bead-Breaking Wedges

Use on passenger, truck, bus, farm, tractor and aircraft tires. Use with soft-face hammers Breaks beads quickly and easily. Handle serves as lever to push bead away from rim.

### WEDGES

Part #	EDP #	Description	Replacement Handle	Length	Head Weight
T11E®	35329	Wood-Handled Wedge	T11EH	30" (76.2cm)	8 1/2 lbs. (3.9kg)
TG11E	35429	Fiberglass-Handled Wedge	TG11EH	32" (81.3cm)	8 1/2 lbs. (3.9kg)

### REPLACEMENT HANDLES

Part #	EDP #	Description	For Hammer No.	Length	Head Weight
T11EH	35129	Hickory Replacement Handle	T11E	30" (76.2cm)	1 1/4 lbs. (.6kg)
TG11EH	35229	Fiberglass Replacement Handle	TG11E	32" (81.3cm)	3 lbs. (1.4kg)



## T26A (32126) Bead-Breaking Tool/Driving Iron

Driving iron is used for loosening rusted truck and bus beads. Tool blade is forged extra wide and curved to fit the rim. Will speed truck repair work and save labor time.

Length	Stock	Weight
11 3/4" (29.9cm)	1 1/4" (32mm)	3 3/4 lbs. (1.7kg)



T41



T42



T52



Part #	EDP #	Description	Length	Stock	Weight
T41	33341	Swan Neck	30" (76.2cm)	7/8" (22mm)	5 1/2 lbs. (2.5kg)
T42	33342	Forcing Tool for 5" rims	30" (76.2cm)	7/8" (22mm)	4 3/4 lbs. (2.2kg)
T52	34652	Bead Breaker Leverage Bar	33" (83.8cm)	7/8" (22mm)	5 1/2 lbs. (2.5kg)

## Bead-Breaking Tools Truck/Farm/OTR

These lightweight, portable tools are a great alternative to the handled bead breaking wedges or hydraulic bead breakers. One end is used to remove frozen or rusted beads from all types or rims. The other end can be used as a leverage bar when inserted into the 35695 or 35697 Truck Wrench.

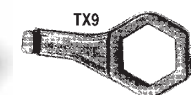

TX-200

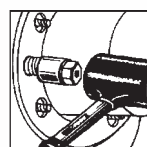
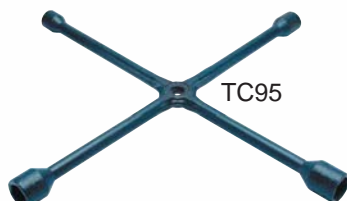
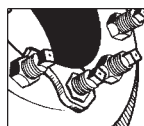

Special Self-Tapping Spines

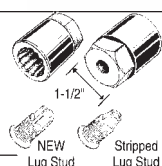
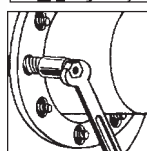

NEW Lug Stud Stripped Lug Stud



### 30165 Dual Wheel Lug Stud Remover

Special self-trapping splines provide maximum grip to remove stripped lug studs. Use with TR1, TR98 truck wrenches. Can also be used with open end wrench. Limited use. Use with soft-faced hammer. Weight: 1 lb. (.5kg)

### Budd Nut Wrenches

Wrenches hold outer cap nut on dual wheels while turning inner nut. Lip fits in hole to secure wrench in place. Sizes offered fit standard and metric Budd nuts.

Part #	EDP #	Description	Size	Weight
TX-9®	30609	SAE & Metric	1 1/2" (38mm)	14 oz. (.45kg)
TX-200	30618	SAE	1-1/2"	2.6 lbs (1.2kg)
TX-241	30619	Metric	41mm	2.6 lbs (1.2kg)

### Heavy-Duty Truck 4-Way Lug Wrench

Use on heavy-duty truck, bus and tractors. Drop-forged or welded center provides strength and durability. T95 wrench has center hole for a leverage bar. Socket sizes provided fit most metric or SAE lug nuts on today's trucks. Stock: 1" (25mm). Made in USA.

Part #	EDP #	Length	Socket Size	Weight
T95	35695	27 1/2" (69.9cm)	1 1/6, 1 1/4, 1 1/2, 13/16" Square	13 1/2 lbs. (6.1 kg)
TC95	35595	27 1/2" (69.9cm)	1 1/2, 13/16" Square, 30, 33 mm	14.2 lbs. (6.4 kg)

### SAE

Part #	EDP#	Socket Sizes	Weight
TR1	32501	1 1/8" Hex with 13/16" Square x 1 1/2" Hex	4 1/2 lbs. (2.0 kg)
TR2	32502	1" Hex with 5/8" Square x 1 1/4" Hex	4 1/2 lbs. (2.0 kg)
TR3	32503	7/8" Hex X 1 1/16" Hex	4 1/2 lbs. (2.0 kg)
TR2X	32504	15/16" Hex X 7/8" Hex	4 1/2 lbs. (2.0 kg)
TR3A	32505	1 1/16" Hex X 1 1/8" Hex	4 1/2 lbs. (2.0 kg)
TR3X	32506	1 1/16" Square X 1 3/16" Square	4 1/2 lbs. (2.0 kg)
TR98	32508	1 1/2" Hex X 13/16" Square	4 1/2 lbs. (2.0 kg)
TR9	32509	1 1/4" Hex X 1 1/16" Hex	4 1/2 lbs. (2.0 kg)

### METRIC

Part #	EDP#	Socket Sizes	Weight
TRM1	32551	17 mm Square X 35 mm	4 1/2 lbs. (2.0 kg)
TRM2	32552	24 mm X 33 mm	4 1/2 lbs. (2.0 kg)
TRM3	32553	27 mm X 30 mm	4 1/2 lbs. (2.0 kg)
TRM4	32554	24 mm X 33 mm	4 1/2 lbs. (2.0 kg)
TRM5	32555	20 mm X 38 mm	4 1/2 lbs. (2.0 kg)
TRM6	32556	21 mm X 41 mm	4 1/2 lbs. (2.0 kg)
TRM7	32557	30 mm X 33 mm	4 1/2 lbs. (2.0 kg)

### Double-End Truck Wrenches

Use on trucks, buses, farm and off-road vehicles. Great for on-the-road service. Sizes available for all SAE and metric lug nuts. All wrenches are constructed from 1" alloy steel for long-lasting strength. Wrenches have an extra deep 1 1/2" socket. Use TR5 truck wrench handle or 3/4" hex leverage bars. Length: 16". Made in USA.

### Truck Wrench Handles and Leverage Bars

Handle is extra-long for increased leverage and heat-treated for extra strength.

### TR10 (34401) Heavy-Duty Truck Wrench

Use for off-the-road Budd type wheels. Use TR11 handle. Stock 1 1/4".

Part #	EDP #	Description	Length	Stock	Weight
TR5	32318	Truck Wrench Handle	22" (55.9cm)	3/4" Hex	3 lbs.
TR11	34402	Truck Wrench Handle	30" (76.2 CM)	1" Round	6 1/2 lbs.

Part #	Length	Socket Sizes	Weight
TR10	29 1/2" (74.9 cm)	1 3/4" Hex and 15/16" Square	12 1/2 lbs. (5.7 kg)





### Lock Ring Tools

These tools are designed to remove lock rings on most trucks on the road today. A must have for anyone mounting or demounting multi-piece rims.

Part #	EDP #	Description	Length	Stock	Weight
T23	32123	Truck Lock Ring Remover Designed especially for Firestone RH and TI rims	24" (61cm)	11/16" (17.5cm)	2 1/4 lbs. (1.0kg)
T23A	33223	Truck Lock Ring Remover Designed Especially for Firestone RH And RI rims	30" (76.2cm)	11/16" (17.5cm)	2 1/2 lbs. (1.1kg)
T23B	33224	Combination Rim/Ring Tool Flat, tapered end ideal for all round ring & rim work	23 1/2" (59.7cm)	11/16" (17.5cm)	2 1/2 lbs. (1.1kg)
T25	32125	5" Rim Lock Tool For Servicing 5" wide base rims	18" (45.7cm)	5/8" (16cm)	1 3/4 lbs. (.8kg)
T27	32127	Special Lock Ring Tool Long, tapered curved end for R-1 continuous side rings; short curved end for Goodyear rims	18" (45.7cm)	5/8" (16cm)	1 3/4 lbs. (.8kg)
T27A	32128	Lock Ring Tool Remove continuous side rings on two-piece truck rims	18" (45.7cm)	5/8" (16cm)	1 3/4 lbs. (.8kg)

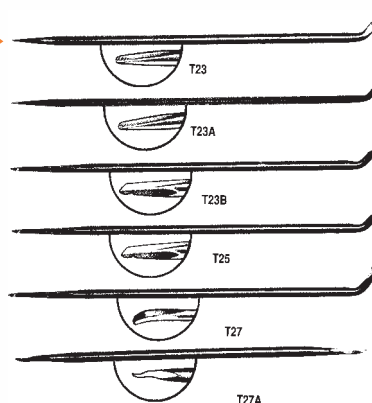

### T-48A (34648) Heavy-Duty Lock Ring Tool

Use for multi-piece wheels, especially hub types.

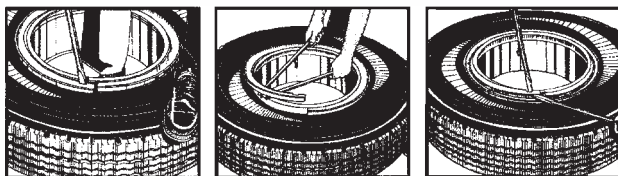

Length: 37" (94cm) Stock: 3/4" (19mm) Weight: 4 1/2 lbs. (2.0kg)

**WARNING:**  
**SAFETY CAGES**

Tire changing can be dangerous and should be done by trained personnel using proper tools and equipment as directed by Federal OSHA Standard No. 29CFT Part 1910.177. Tires may explode during inflation causing injury to operator or bystander. Wear safety goggles. Keep all parts of body outside cage. Use extension hose, clip-on chuck and remote valve. See supervisor for safety procedures.



T105

### Tire Inflation Cages

Mandatory for any shop working with tubeless and multi-piece rims. Made from heavy-gauge steel tubing welded to a steel base. Guards against blown lock rings and rims. Follow safety instructions on cage and OSHA regulation 29-CFR Part 1910.177. Meets OSHA regulation requirements for Medium, Heavy-Duty Truck, OTR, Tractor and Super Singles. Ken-Tool offers a size and design for all your needs. For additional safety instructions, call Haltec customer service.

**WARNING:** Do not alter cage in any way. Cage must be freestanding and at least three feet from other objects. Discard cage if bent, cracked or otherwise damaged

### Aluminum Wheel Protector

Save expensive rims from damage during manual changing. Prevents tire tools from mar-ring or scratch-ing aluminum or steel rims when using Ken-Tool's manual tire changing tools. Durable leather protector fits on rim and protects inside of the rim well.



Part #	EDP #	Description	A Height	B Width	Base	Weight
T102	36002	4-Bar Cage*	43 1/2" (110.5cm)	20 1/2" (52.1cm)	31 1/2 x 26" (80 x 66.0cm)	152 lbs. (69.0kg)
T105	36005	5-Bar Cage*	43 1/2" (110.5cm)	20 1/2" (52.1cm)	41 x 26" (104.1 x 66.0cm)	192 lbs. (87.2kg)

TOLL FREE: 800-321-6471

www.haltec.com

Ken-Tool Products



T47A

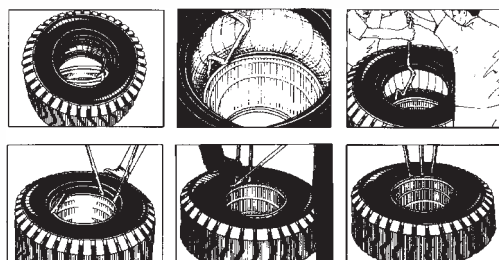

### Tubeless Tire Irons & Sets

Sets provide all irons necessary for a variety of tire changing applications. Use "C" bar with the "B" extension bar for easier use on large, wide-base truck tires. Use on standard and large truck tires, including industrial, farm, buses and tractors.

### STANDARD

Part #	EDP #	Description	Length	Stock	Weight
T46A	34747	Straight Mount/Demount Tool	36" (91.4cm)	3/4" (19cm)	4 1/2 lbs. (2.0kg)

### HEAVY-DUTY

Part #	EDP #	Description	Length	Stock	Weight
T47A	34847	Straight Mount/Demount Tool	52" (132.1cm)	1" (25cm)	11 lbs. (5.0kg)

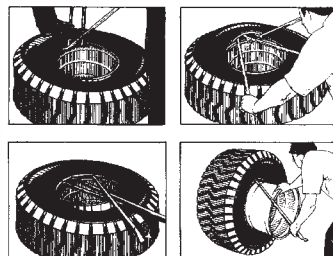

T45A

T45HD

T2001



**Demount Tool**

**Mounting Tool**

T2002

Wing shape is designed to stop against the rim, and then remove itself effortlessly from between the rim and bead. The small end of the tool easily gets under the stretched bead for that last pull.

Demounts both beads on most truck tires without the need for lifting the tire/wheel assembly off the ground, and then dropping it.

Part #	EDP #	Length	Socket Sizes	Weight
T45A®	34645	37" (94.0cm)	3/4" (19mm)	4 1/2 lbs. (2.0kg)
T45HD	34647	41" (104.1cm)	7/8" (22mm)	7 lbs. (3.2kg)
T47A-2000K™	34644	38" (96 cm)	3/4" (19mm)	5 lbs. (2.2kg)

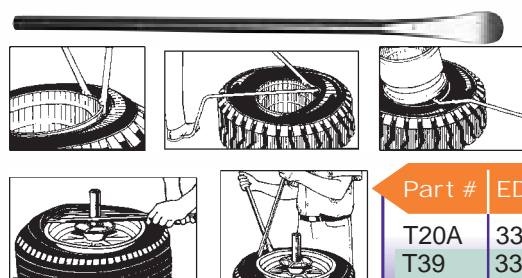

### Tire Mount/Demount Spoons

These irons are designed for fast and efficient tire changing. The 30" spoons provide enough strength and leverage to work on large truck, bus, off-road vehicle, tractor and aircraft tires.

Part #	EDP #	Length	Stock	Weight
T20A	33220	30" (76.2cm)	11/16" (17.5mm)	3 lbs. (1.4kg)
T39	33239	30" (76.2cm)	7/8" (22mm)	4 1/2 lbs. (2.0kg)



### Individual Heavy-Duty Truck Torque Extensions

Convert your own sockets into torque sockets for use on commercial, heavy-duty trucks, and buses.

**WARNING:** Torque sockets and truck torque extensions can not be used to take off wheel nuts. Calibrate your impact gun and follow all manufacturers' recommended procedures when using Torque Master products.

Model	Descrip.	Drive Size Socket/Opening	Torque Limit	Weight
30230	Yellow (O)	3/4"	175 ft/lbs	.75 lbs. (.3 kg)
30231	Yellow (N)	3/4"	250 ft/lbs	.75 lbs. (.3 kg)
30232	Yellow (U)	3/4"	350 ft/lbs	.75 lbs. (.3 kg)
30233	Yellow (M)	3/4"	475 ft/lbs	.75 lbs. (.3 kg)
30236	Yellow (T)	1"	175 ft/lbs	1 lbs. (.5 kg)
30237	Yellow (R)	1"	250 ft/lbs	1 lbs. (.5 kg)
30238	Yellow (S)	1"	350 ft/lbs	1 lbs. (.5 kg)
30239	Yellow (P)	1"	475 ft/lbs	1 lbs. (.5 kg)
30240	Yellow (W)	1"	650 ft/lbs	1 lbs. (.5 kg)

**Ken-Tool Products**

TOLL FREE: 800-321-6471

www.halttec.com



# Ventrex Air Conditioning Valves



## Screw-in versions (pre-assembled versions)

Mercedes Porsche Smart		aluminum	Hi	97.016
			Lo	97.018
BMW Mini		steel	High	97.015
			Low	97.017
trucks		steel		201.055
			Low	201.057
GM		aluminum	High	202.037oK
PSA		aluminum	-	99018mv

## Braze-in versions

Mercedes		aluminum	High	99.001-1 97.030 97.015-3a
Mercedes			Low	99.002-1 97.030 97.017-3a
VW		aluminum	High	99.001-1a 97.030 97.015-3a
VW Audi			Low	99.002-1a 97.030 97.017-3a
VW			High	202.015-1a 97.030 97.015-3a
BMW		aluminum	High	201.030-1 97.030 97.015-3a
BMW		steel	Low	202.028-1 97.030 97.017-3a
BMW		aluminum	High	202.035-1 97.030 97.015-3a
BMW		aluminum	Low	201.078-1 97.030 97.017-3a

## Valve Cores

BMW Mercedes Smart Porsche VW, Audi		valve core	97.030
			97.030EP 97.030FF
			97.030HNBR
PSA GM			
PSA			430HNBR-N

## Valve Caps

		valve cap	EPDM or HNBR o-ring
			EPDM or HNBR o-ring

TOLL FREE: 800-321-6471

[www.haltec.com](http://www.haltec.com)



Part #	Pg. No.	Part #	Pg. No.	Part #	Pg. No.	Part #	Pg. No.	Part #	Pg. No.
41 MS-00	23	077085	55	ALC-16P	50	GA-100	35	H-3167	51
60MS-27	23	077088	55	ALC-PDQ16	50	GA-100-DIS	35	H-3267	51
70 MS-7	2,24	077155	55	ALC-KIT	50	GA-105	35	H-3611	51
70 MS-27	23	077185	55	ALSP	30	GA-105-DIS	35	H-3612	51
80 MS-27	23	077188	55	AQF-1	31	GA-110M	35	H-4000	10
89-COM	64	082012	56	ASP-1	41	GA-115	35	H-4000-1	10
89TRL	3,44	082122	56	ASP-10	37	GA-115-DIS	35	H-4167	51
90 MS-27	23	082133	56	B-6	30	GA-120M	35	H-4361	28
114S-5 1/2	6	110203	56	B9A	30	GA-125	35	H-4660A	38
114S-11	6	89 MDA	42	B9-2	33	GA-130	34	H-5007	28
115 MS-27	23	89XDA	42	B-222	11,12,33	GA-135	34	H-5167	51
57	13	89XDB	42	BBH-10	57	GA-135ADJ	34	H-5265	39
307	31	89XDB-G	44	C-10	5	GA-135S	34	H-5267	51
310	31	89XDZ	42	C-100	11	GA-140	34	H-6116	28
322	38	89HKC-12	43	C-155	11	GA-145	35	H-6116B	28
326	38	89HKC-24	43	CH-305	39	GA-146	35	H-6167	51
328	38	89HKC-25C	43	CH-305-OP	39	GA-150	34	H-7167	51
377	38	89HKC-50	43	CH-315	39	GA-155	34	H-7607	28
451	33	89HKC-50C	43	CH-315-OP	39	GA-155ADJ	34	H-8167	51
452	33	89HKT-12	43	CH-318	39	GA-155-DG	3,34	H-8864	2,26,50
453	33	89HKT-24	43	CH-320	35	GA-155S	34	H-8964	2,26,50
463	33	89HKT-50	43	CH-300	40	GA-155S-RCL	3,34	H-9167	51
464	33	89-2WASV	43	CH-330-LO	40	GA-160	34	H-9267	51
500	54	89-3WASV	43	CH-330-LO-1	43	GA-165	34	H-11167	51
568-011G	45	89-3WTK	43	CH-330-LO-OP	43	GA-170	34	H-11911	51
600	55	89HKT-24M	43	CH-333-LO	40	GA-175	34	H-11912	51
753S-Length	8	89HKT-24M	43	CH-335	40	GA-185	34	H-12167	51
810F-Length	9	89HKT-24M	43	CH-340	39	GA-185S	34	HE-200	27
867-Length	9	89HKT-24M	43	CH-340-OP	39	GA-190	35	HE-201	27
977S-5 1/2	6	89HKT-24M	43	CH-350-LO	40	GA-240	37	HE-202	27
977S-11	6	89HKT-24M	43	CH-355-LO	40	GA-250	37	HE-350 Series	27
5012	52	89HKT-24M	43	CH-360	39	GA-250S	37	HE-350D Series	27
5014	52	89HKT-24M	43	CH-360-1	43	GA-255	37	HE-370 Series	26
5120	52	89HKT-24M	43	CH-360-OP-1	39,43	GA-255S	37	HE-380 Series	26
5131	37	89HKT-24M	43	CH-370-LO	40	GA-274	36	HE-390 Series	26
5716	52	89HKT-24M	43	CO-101	48	GA-276	36	HE-4430	26
5916	52	89HKT-24M	43	CO-103	48	GA-285	36	HN-17	33
5976-5	33	89HKT-24M	43	CO-105	48	GA-289	36	HN-18	33
5976-6	33	89HKT-24M	43	CO-107	49	GA-290	36	HN-21	33
5988L	52	89HKT-24M	43	CO-109	49	GA-850-330	36	HN-22	33
5988R	52	89HKT-24M	43	CO-111	49	GA-850-350	36	HX-24	29
5995L	52	89HKT-24M	43	CO-111R	49	GA-850-370	3,36	HX-44	29
5995R	52	89HKT-24M	43	CO-112	49	H-22	56	I-400	47
5996L	52	89HKT-24M	43	CO-201	48	H-41	5,8	I-401	47
5996R	52	89HKT-24M	43	CO-204	49	H-42	8	I-402	47
6185	13	89HKT-24M	43	CO-301	48	H-43	7	I-404	47
6190	13,38	89HKT-24M	43	CO-303	48	H-45	8	I-405 Series	46
7896R	52	89HKT-24M	43	CO-501	48	H-47	7,29	I-406M	46
7896L	52	89HKT-24M	43	CO-701	48	H-50	15,30	I-408	47
8807N-3	32	89HKT-24M	43	CO-800	49	H-78	53	I-409	47
8807N-4	13,32	89HKT-24M	43	CO-801	49	H-79	53	I-415 Series	46
8909-C	4,41	89HKT-24M	43	DS-1	27,32	H-150	53	I-420	46
008221	56	89HKT-24M	43	DS-210	14	H-155	54	I-430 Series	46
008222	2,56	89HKT-24M	43	DS-210P	14	H-180	53	IN-20	3,43,45
10008	33	89HKT-24M	43	DS-215	14	H-181	53	IN-80A	13
10009	33	89HKT-24M	43	DS-226	14	H-182	53	K-431	5
10013	38,47	89HKT-24M	43	DS-296	14	H-183	53	K-665	11
10058	33	89HKT-24M	43	DS-385	7	H-185	55	LB-216 Thru LB-231	10
10071	33	89HKT-24M	43	DS-390	7	H-188	55	LN-1	33
30165	58	89HKT-24M	43	DS-400-Length	7	H-190	53	LN-10	30
30230	2,62	89HKT-24M	43	DT-105	3,36	H-501OV	25	LN-10B	30
30231	62	89HKT-24M	43	E-3100-1	13	H-523MS	23	LR-Size	22
30232	62	89HKT-24M	43	E-3100-4A	13	H-556	28	M-1870	15
30233	62	89HKT-24M	43	FE-300-Length	27	H-798	28	M-1900 Length	11
30236	62	89HKT-24M	43	FMB-Length	21	H-1503	53	M-1950 Length	11
30237	62	89HKT-24M	43	FP-130 Series	31	H-1611	51	M-2000	14
30238	62	89HKT-24M	43	FP-140 Series	31	H-1612	51	M-5000	15
30239	62	89HKT-24M	43	FP-150 Series	31	H-1681	51	MB-3	21
30240	62	89HKT-24M	43	G-160	33	H-1813	53	MB-5A	21
39874	52	89HKT-24M	43	G-162	33	H-2125	26	MB-8	21
001102	2,56	89HKT-24M	43	G-165	33	H-2126	26	MB-12-75	20
001103	56	89HKT-24M	43	G-166	33	H-2127	26	MB-12-85	20
039946	52	89HKT-24M	43	G-170	33	H-2167	51	MB-13	20
076015	54	89HKT-24M	43	G-170S	33	H-2225	26	MB-14	20
076085	54	89HKT-24M	43	G-172	33	H-2227	26	MB-19-75	20
076088	54	89HKT-24M	43	G-174	33	H-2245	26	MB-19-85	20
076155	54	89HKT-24M	43	G-201	13	H-2246	26	MB-20	20
076185	54	89HKT-24M	43	G-202	13	H-2247	26	MB-23	21
076188	54	89HKT-24M	43	G-204	13	H-2257	26	MB-25	20
077015	55	89HKT-24M	43	G-206	13	H-2755	28		

Part #	Pg. No.	Part #	Pg. No.	Part #	Pg. No.	Part #	Pg. No.	Part #	Pg. No.
MBF-Length	21	R-525	11,12	TRM3	60	TV-602-HP	25		
MB-26	20	R-529-5 1/4	12	TRM4	60	TV-618A	30		
MB-27	20	R-625	12	TRM5	60	TV-618B	30		
MB-29-85	20	R-660	12	TRM6	60	TV-621A	30		
MBAT	21	R-675	12	TRM7	60	TV-622A	30		
MR-800-Length	14	R-685	12	TX-9	60	TV-623A	30		
MR-850-Length	14	R-760	11,12	TX-200	60	TV-801-HP	25		
MR-890-Length	14	R-761	21	TX-241	60	TV-802-HP	25		
MT-3000-Length	12	R-762S	11,12	T-30	30	TV-916R	30		
MT-4000-Length	14	R-763	11,12	T-81	11,15	TV-6008	23		
NITRO-1	45	R-764R	11,12	T-82	11	TV-6008C	23		
N-1000	30	R-969-K	12	T-670	7	TV-6010	25		
N-1012S	30	R-969K-1	12	T-2001	2,61	TV-6020	25		
N-1019	29	RK-800	6	TC-50	29	TV-6030	25		
N-1050	15	RK-810	6	TC-60	29	TV-6040	25		
N-1055	36	RK-820	6	TC-70	29	TV-CH-1	30		
N-1057	31	RK-830	6	TGG-1	34	TV-CH-3	30		
N-1066	15	RK-840	6	TL-132	40	W-1101-1	33		
N-1091	3,31	RK-850	6	TL-133	40	WH-44-Lengths	4,7		
N-1091-2	31	RV-1077A	27	TL-134	40	WH-45-Lengths	4		
N-1091-3	31	RV-1078A	27	TL-610	41	WH-46-Lengths	4		
N-1135	32	RV-1175A	27	TL-612	41	WH-47-Lengths	4		
N-1147	25	RV-1177A	27	TL-615	41	WH-48-Lengths	4		
N-1199	39	RV-1179A	27	TL-620	41	WH-49-Lengths	4		
N-1200	39	S-85	11	TL-625	41	WH-50-Lengths	4		
N-1202	32	S-85-D	11	TL-630	41	WH-51-Lengths	4		
N-1410	37	S-7910	15	TL-631	38	WH-52-Lengths	4		
N-1418	2,4	S-8860	15	TL-632	41	WH-53-Lengths	4		
N-1420H	35	SFE-400-Length	27	TL-633	41	WH-54-Lengths	4		
N-1451	31	STAND	4,43,45	TL-634	18	WH-55-Lengths	4		
N-1452	31	TALON-1	57	TL-635	41	WH-56-Lengths	4		
N-1510	36	T11E	59	TL-645	41	WH-57-Lengths	4		
N-1538B	15	T11EH	59	TL-645-24	41	WH-58-Lengths	4		
N-1543A	15	T20A	62	TL-650	41	WH-59-Lengths	4		
N-1600	24	T23	61	TL-665	41	WH-70-J-661-			
N-1610	38	T23A	61	TL-680	37	Series	5		
N-1710	38	T23B	61	TL-685	41	WH-70-J-664			
N-1810	38	T25	61	TL-690	37	Series	5		
N-1910	38	T26A	59	TL-695	37	WH-70-J-667	5		
NI-102	48	T26B	59	TL-700	21	WH-71-J-9	5		
NI-104	48	T27	61	TL-LN-10	38	WH-72-J-Series	5		
NI-106	48	T27A	61	TV-218R	30	WH-73-J-21 1/4	5		
NI-108	49	T39	62	TV-220R	30	WH-75-J-Series	5		
NI-110	49	T41	59	TV-399	29	WH-300-J-650			
NI-112	49	T42	59	TV-400	29	Series	4		
NI-113	49	T45A	62	TV-401	29	WH-330-J-690			
NI-202	48	T45HD	62	TV-402	29	Series	7		
NI-204	48	T46A	62	TV-412	25	WH-JF-994	6		
NI-206	49	T47A	62	TV-413	25	WHD-Series	10		
NI-208	49	T47A 2000K	62	TV-413-CH	25	WHG-Series	10		
NI-502	48	T48A	61	TV-414	25	ZBFE-Length	16		
NI-504	48	T52	59	TV-415	25	ZFAK	17		
NI-702	48	T95	60	TV-416	25	Z2-2	17		
NI-704	48	T102	61	TV-416/DS-1	24	Z3-75	16		
O-320	33	T105	61	TV-416L	25	Z3-80	16		
O-330L	33	T2001	2,62	TV-416LF	24	Z11	17		
OR-Size	22	T2002	62	TV-416MC	24	Z3-90	16		
OTR-1825	57	TC95	60	TV-417	23	Z-1	16		
OTR-2000	57	TG11E	59	TV-418	25	Z-2	16		
P-15	30	TG11EH	59	TV-418-CH	25	Z-4	16		
P-250	31	TR1	60	TV-423	25	Z-5	17		
P-251	31	TR2	60	TV-425	25	Z-7	17		
P-252	31	TR2X	60	TV-430	23	Z-8	17		
PC-1	29	TR3	60	TV-500	23	Z-9	17		
PC-2	29	TR3A	60	TV-501	23	Z-10	17		
PC-3	29	TR3X	60	TV-509	23	Z-12	17		
PC-4	29	TR5	60	TV-510	23	Z-13	16		
PC-5	29	TR9	60	TV-511	23	Z-100	17		
PTC	18,19	TR10	60	TV-513	25				
PT-EX	18	TR11	60	TV-515	25				
PT Gauge	18,19	TR98	60	TV-540 Series	24				
PT-H-42	19	TRL-BAT	45	TV-570	23				
PT-R-520	18,19	TRL-H-25	45	TV-571	23				
PT-45-6	19	TRL-H-IN-20	45	TV-572	23				
PT-300-J-650	19	TRL-H-CH-360-OP	45	TV-573	23				
PT-330-J-690	19		45	TV-574	23				
PT-330-3 1/2	19	TRL-H-N1200	45	TV-575	23				
PT-753S-6	19	TRL-COUP	45	TV-575-HP	23				
R-372	15,30	TRM1	60	TV-575HP/DS-1	24				
R-520	11,12,13	TRM2	60	TV-600-HP	25				

BEAD BREAKERS

COUPLERS

SERVICE GAUGES

L-RINGS

GROMMETS

BUS VALVES

VALVE EXTENSIONS

HYDRAULIC RAMS & JACKS

SUPER LARGE BORE VALVES

O-RINGS

ADAPTERS

HEX NUTS

PT VALVES

CAPS

ALCOA WHEEL ACCESSORIES

LARGE BORE VALVES

Z-BORE VALVES

MEGA BORE VALVES

DIAL GAUGES

**HALTEC**  
CORPORATION  
SINCE 1970



SHIPPING ADDRESS:

2556 State Route 9  
Salem, Ohio 44460

MAILING ADDRESS:

P.O. Box 1180  
Salem, Ohio 44460

PHONE: 330-222-1501

TOLL FREE:

800-321-6471

US & Canada

FAX: 330-222-2302

[www.haltec.com](http://www.haltec.com)